



Installation Instructions

RB 500 Manual Roller Shades

Heavy Duty Crank Operated

5-215 Series-Crank Operation

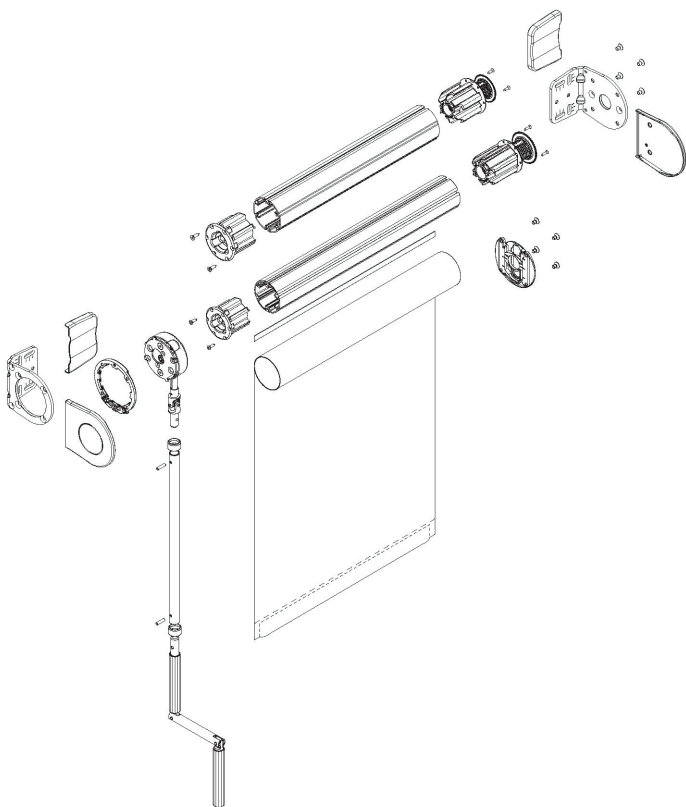

HunterDouglas 
Architectural

Installation

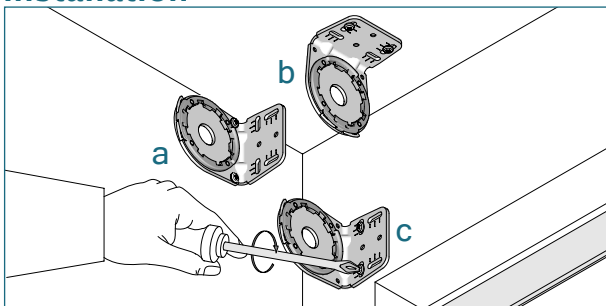

Install the brackets with the screws provided.

a) recess b) ceiling c) wall

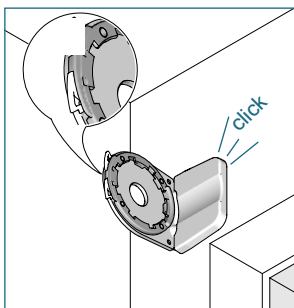
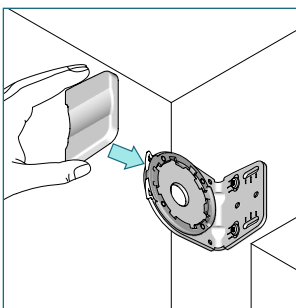

Slide the screw cover onto the bracket until it snaps. The fastener on the bracket adapter must be open.

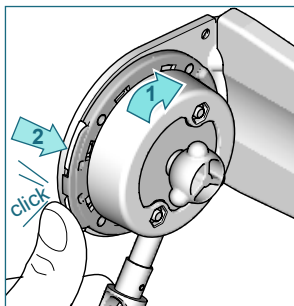
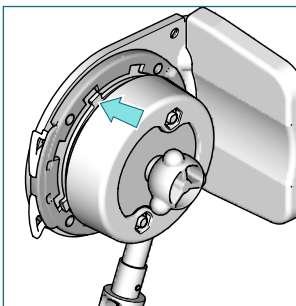

Slide the crank into the bracket adapter, turn it (10°) in the rolling off direction (1). Close fastener to secure the crank.(2)

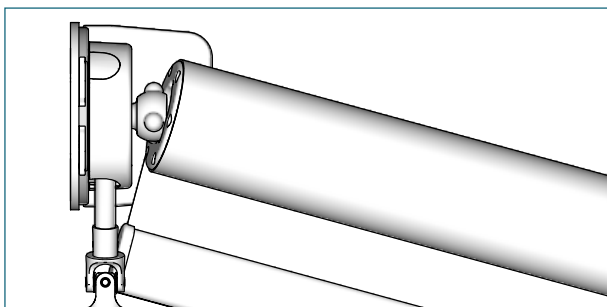

Place the tube adapter on the crank head.

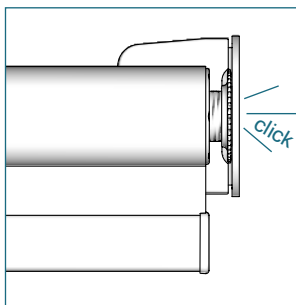
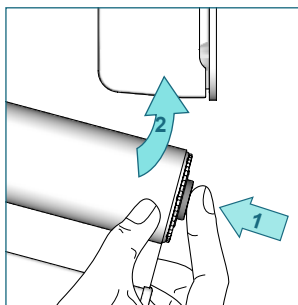

Press the tube bearing plug (1), lift the shade and snap into the bracket.

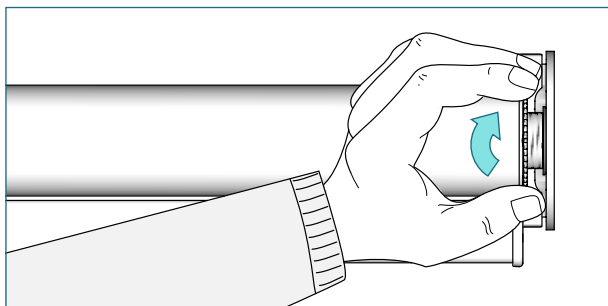

Secure the shade by turning the locking ring furthest away from the bracket.

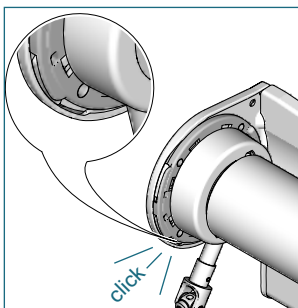
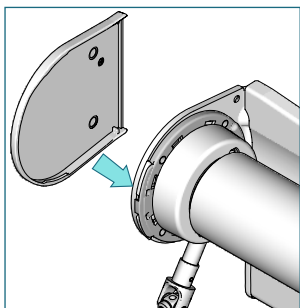

Slide the bracket covers onto the brackets. Make sure the bracket covers snap onto the brackets.

Option: Leveler

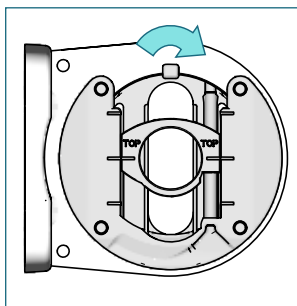
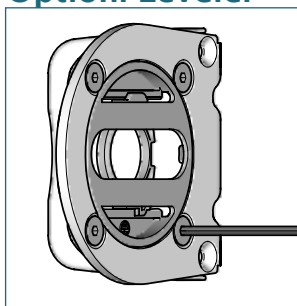

Make sure that the opening for the Allen key is pointing downwards before installing the brackets. Change the orientation by loosening the 4 screws and by turning the leveler 90°. Reinstall the screws.

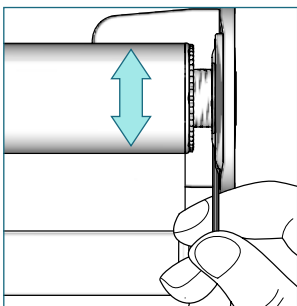
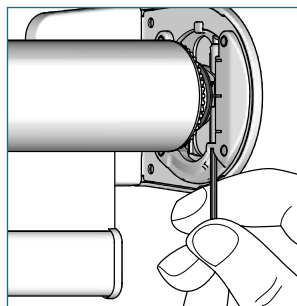

To adjust skewing, put the provided Allen key into the screw of the leveler and turn it left or right to move the shade up and down. Support lifting of large heavy shades with the palm of your hand.

Removal

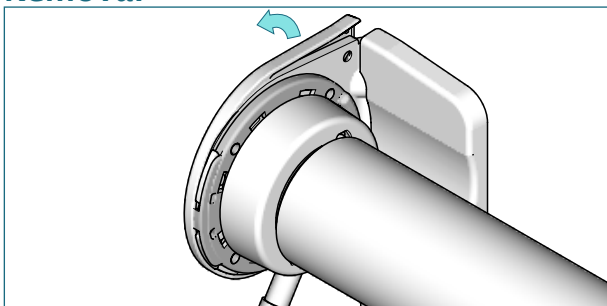

Lift the backside of the bracket cover ...

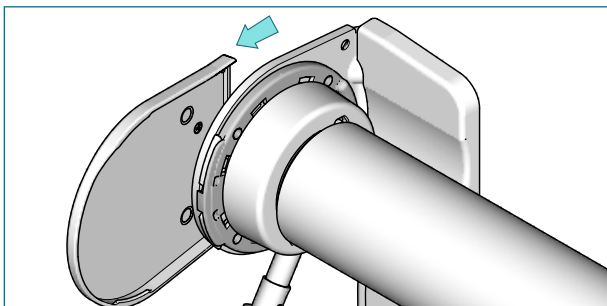

... and slide it towards you.

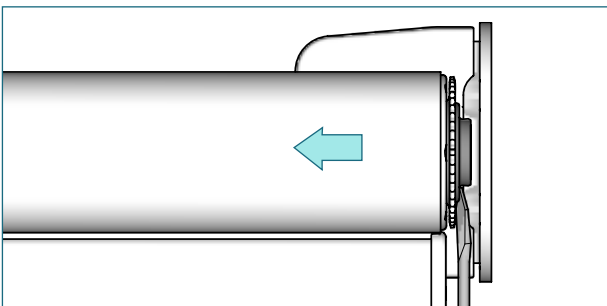

Unfasten the locking ring. Slide a screw driver between locking ring and bracket and push the tube bearing plug in the crank direction.

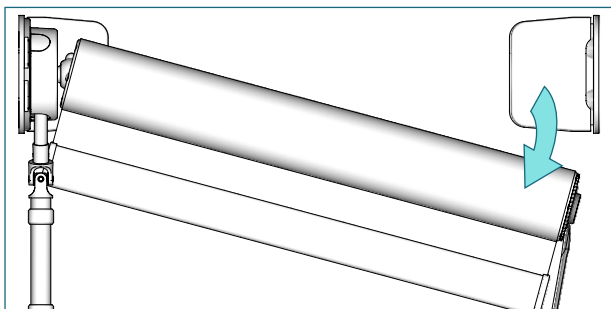

Move the shade downwards out of the bracket.

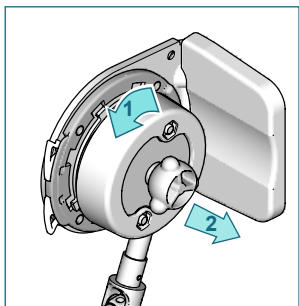
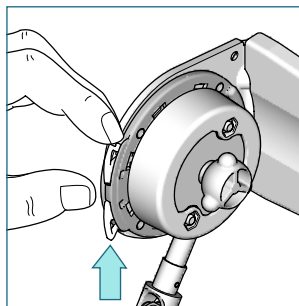

Open the fastener of the bracket adapter. Turn the crank in the roll up direction until the crank can be pulled out of the bracket adapter.