



Installation Instructions

RB 500 Manual Roller Shades

Standard Crank Operated

5-15 Series-Crank Operation

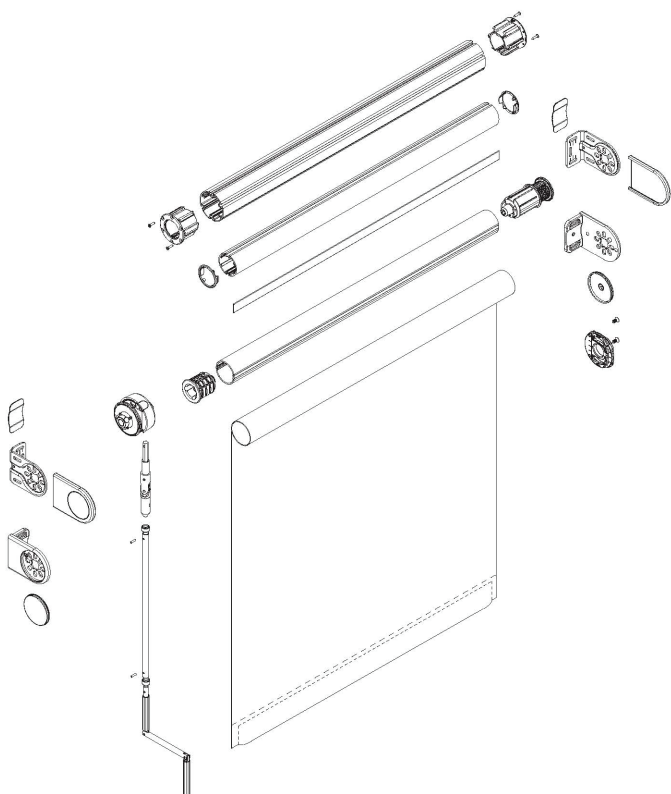

HunterDouglas 
Architectural

Installation

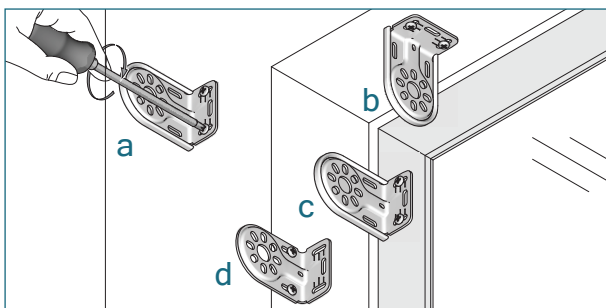

Install the brackets with the screws provided.
a) on face wall b) on ceiling c) on frame d) in recess

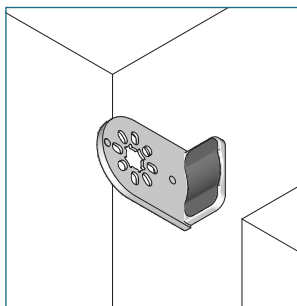
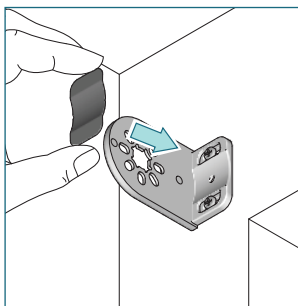

When using decorator brackets, slide the screw cover cap onto the bracket until it snaps.

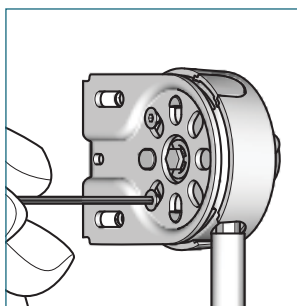
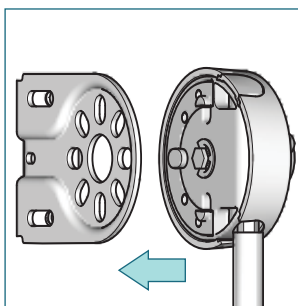

Place the crank in the bracket and attach both screws.

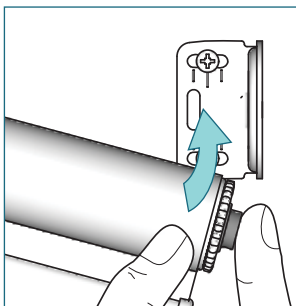
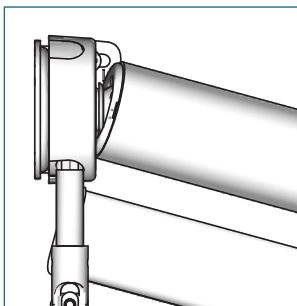

Place the tube on to the crank head. Press the tube bearing plug and lift the shade.

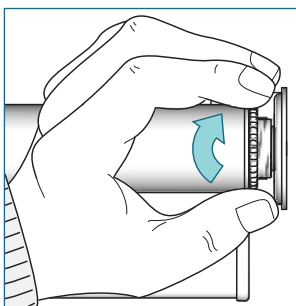
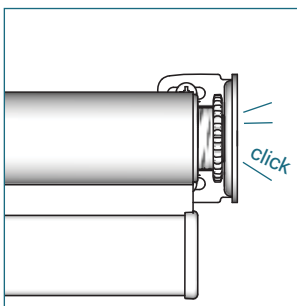

Snap it to the bracket. Secure the shade by turning the locking ring furthest away from the bracket.

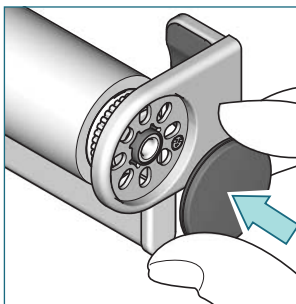
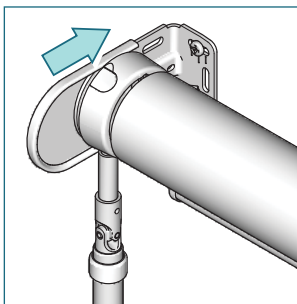

Slide the bracket covers on to the brackets. Insert the bracket covers into the decorator bracket.

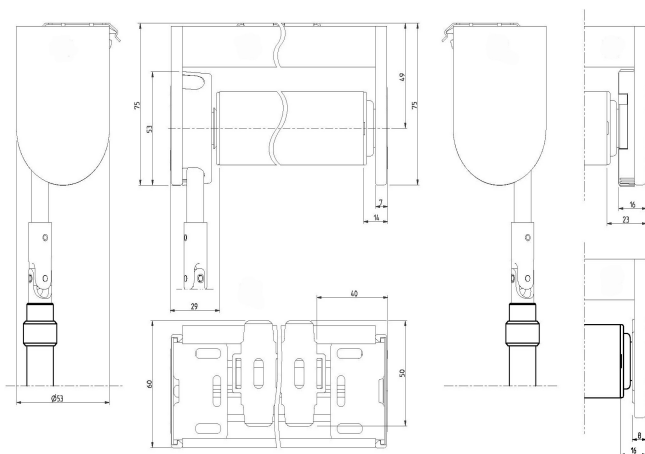

Option: Integrated Leveler

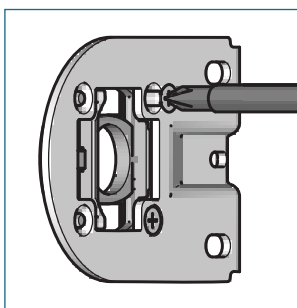
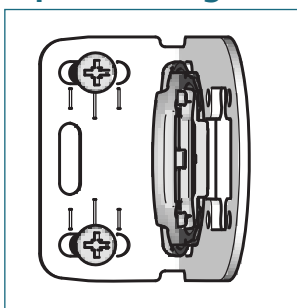

Make sure that the opening for the Allen key is pointing downwards before installing the brackets. Change the orientation by loosening the 2 screws and turning the leveler 90°. Reinstall the screws.

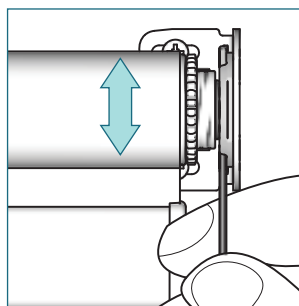
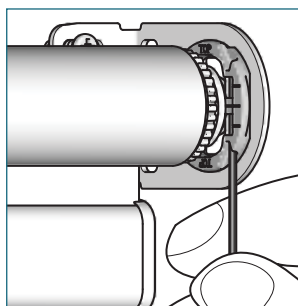

To adjust skewing, put the provided Allen key into the screw of the leveler and turn it left or right to move the shade up or down. Support lifting of large heavy shades with the palm of your hand.

Removal

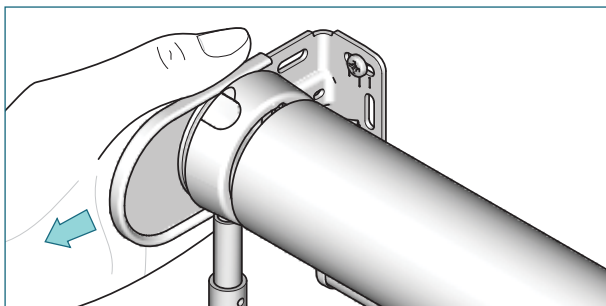

Slide the bracket cover towards you.

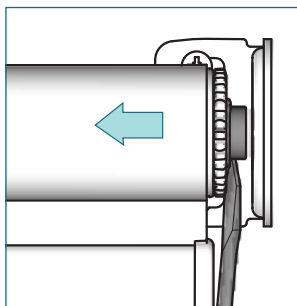
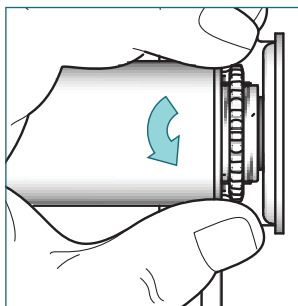

Unfasten the locking ring. Slide a screw driver between locking ring and bracket and push the tube bearing plug in the crank direction.

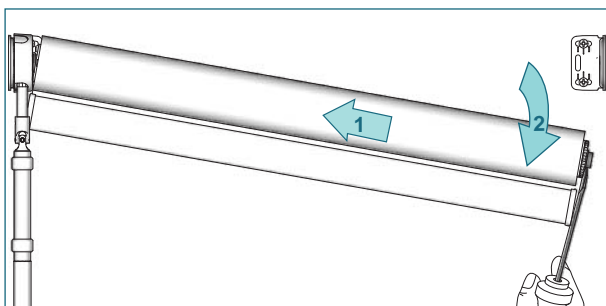

Move the shade downwards out of the bracket.

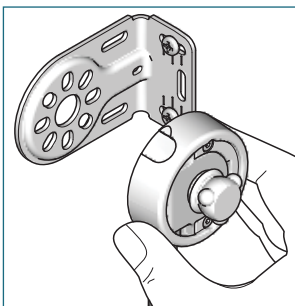
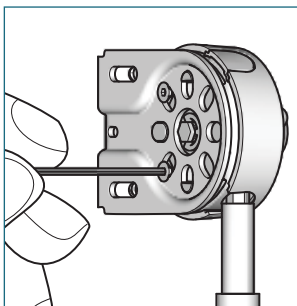

Loosen both screws and take the crank out of the bracket.

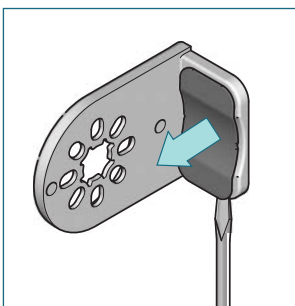
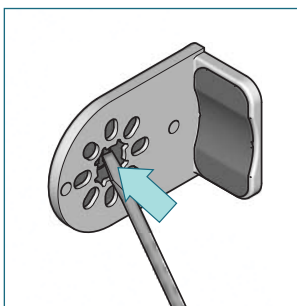

Press the bracket cover out of the decorator bracket. Use a screw driver to remove the screw cover cap from the decorator bracket.