

HunterDouglas

Installation • Operation • Care



Provenance[®] Woven Wood Shades
EasyRise[™], UltraGlide[®], and LiteRise[®]
Lifting Systems

CONTENTS

Getting Started:

Product View	1
Product View — Crestover™ Valance.....	2
Tools and Fasteners Needed	3

Installation:

Installation Overview	4
Mount the Installation Brackets — Inside Mount.....	6
Mount the Installation Brackets — Outside Mount	7
Install the Shade	8
Attach the Optional Components	8
Attach the Universal Cord Tensioner — EasyRise™ Only.....	10

Operation:

Operate the Shade	11
Independent Operable Liner with PowerView™ Motorization	13
Troubleshooting	14

Care:

Removing the Shade (If Necessary)	15
Removing the Crestover Valance (If Necessary)	15
Cleaning Procedures	16

Child Safety:

Warning	17
Cord Loop Shades.....	17

Questions?

Contact a Customer Service representative at
1-800-727-8953.



Product View

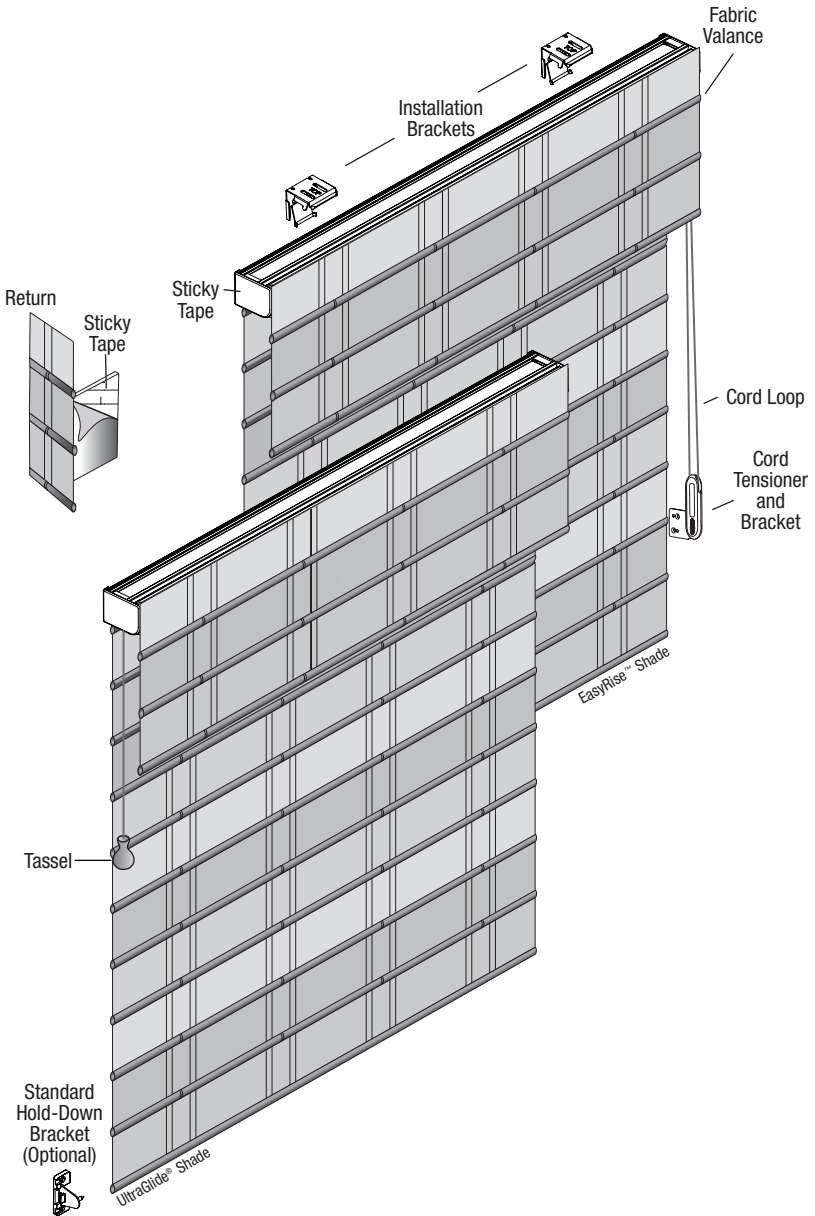

Not Shown: Top-Down/Bottom-Up, LiteRise® and Independent Operable Liner shades

Product View — Crestover™ Valance

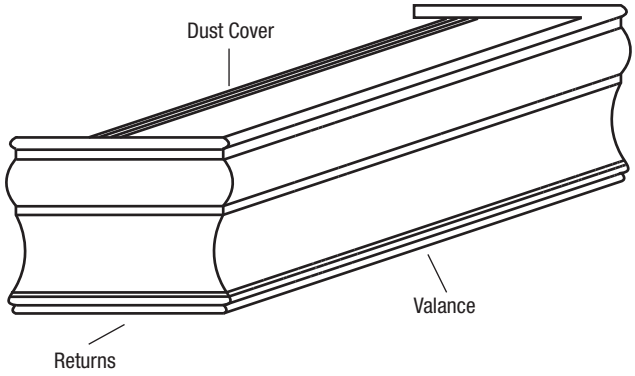

Thank you for purchasing Hunter Douglas Provenance® Woven Wood Shades. With proper installation, operation, and care, your new shades will provide years of beauty and performance.

Please thoroughly review this instruction booklet and the enclosed packing list before beginning the installation.

Tools and Fasteners Needed

- Flat blade and Phillips screwdrivers
- Level (laser level is recommended)
- Measuring tape and pencil
- Power drill, $\frac{3}{32}$ " drill bit, and $\frac{1}{4}$ " hex driver

In addition, you will need fasteners designed to work with your specific mounting surface(s).

- **#6 Hex Head Screws (Provided).** Two $1\frac{1}{2}$ " screws are provided per installation bracket.
- **Speed Nuts and Screws (Provided).** Extension brackets come with speed nuts and screws.
- **Drywall Anchor (Not Provided).** Use drywall anchors when mounting into drywall.



#6 x $1\frac{1}{2}$ "
Hex Head Screws
(Provided)



Speed Nuts
and Screws
(Provided with Each
Extension Bracket)

INSTALLATION

Installation Overview

- Your order will include the correct number of installation brackets for your shade width, as shown in the table below.

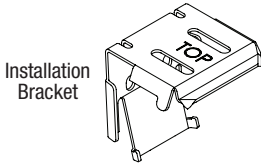

Shade Width	Brackets Required
15" – 36"	2
36 $\frac{1}{8}$ " – 72"	3
72 $\frac{1}{8}$ " – 108"	4
108 $\frac{1}{8}$ " – 120"	5
120 $\frac{1}{8}$ " – 144"	6

- **Crestover™ Valance (Optional)**

- Brackets are already attached to your shade and valance.

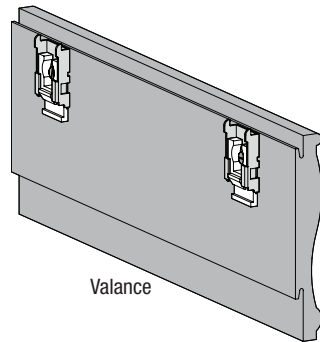
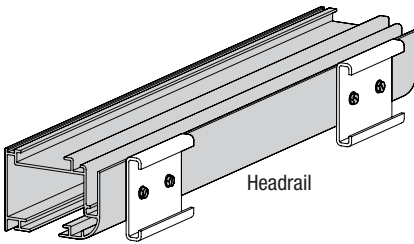

Mounting Types and Window Terminology

If the installation brackets are mounted correctly, the rest of the installation process follows easily. To prepare for this important first step, review the mounting types and basic window terminology illustrated below.

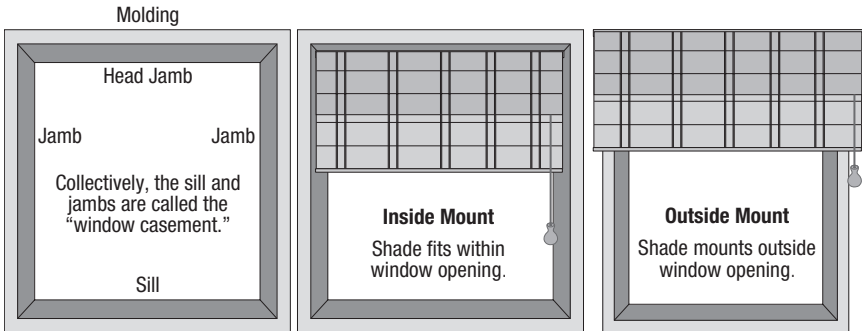

■ Refer to the appropriate page below based on your order:

➤ **Inside Mount — page 6**

➤ **Outside Mount — page 7**

INSTALLATION

Mount the Installation Brackets — Inside Mount

IMPORTANT: If your shade has PowerView™ Motorization as a lifting system for an independent operable liner, please refer to the PowerView Motorization *Installation, Operation, and Care* manual for installation and operation.

- Mark 2" in from each jamb.
 - If more than two installation brackets came with your order, space additional bracket(s) evenly between the two end brackets and mark their location. Mount into wood whenever possible.

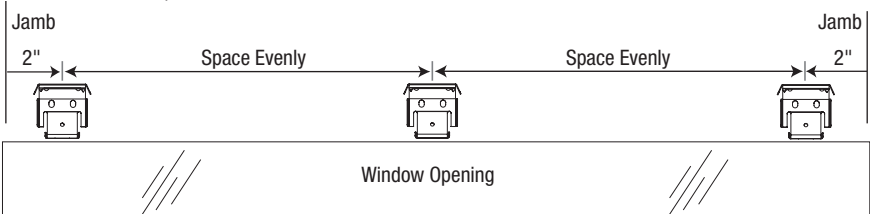

- Center the brackets on your marks, then mark each of the screw holes.
 - For fully recessed mounting, the fabric will be flush with the front of the window casement, when raised. A minimum depth of 3" is needed to fully recess your shade.
 - Minimum mounting depth for bracket attachment is $\frac{7}{8}$ ".

IMPORTANT: The front edges of the installation brackets must be level and aligned.

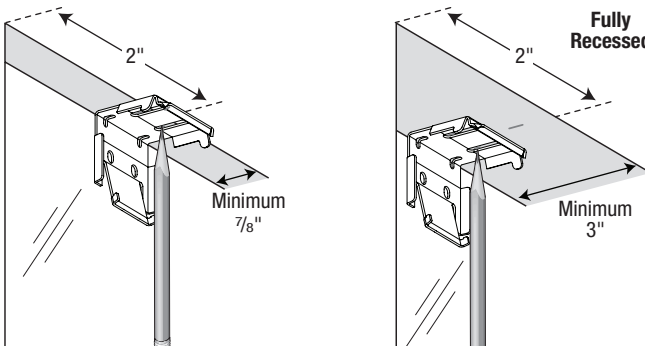

- Drill the screw holes using a $\frac{3}{32}$ " drill bit.
- Attach the installation brackets using the screws provided.
 - Check that the mounting surface is level and the brackets are aligned. If mounting to a heavily textured surface, shim the brackets, if needed.

IMPORTANT: Use drywall anchors when mounting into drywall.

Proceed to "Install the Shade" on page 8.

Mount the Installation Brackets — Outside Mount

- Center the headrail over the window opening at the desired height. Use a pencil to lightly mark each end of the headrail.
 - Alternatively, measure the width of the headrail and use that width to mark the headrail end points over the window opening.
- Mark 2" in from each end of the headrail.
 - If more than two installation brackets came with your order, space additional bracket(s) evenly between the two end brackets and mark their location. Mount into wood whenever possible.

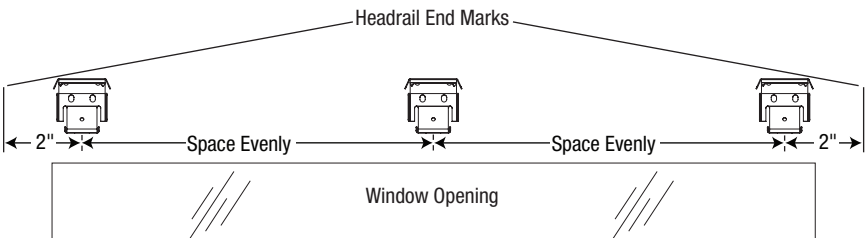

- Center the brackets on your marks and mark the screw holes.

- A minimum of 1³/₄" flat vertical surface is required to mount the brackets.
- The top of the installation brackets should be at the desired shade height.

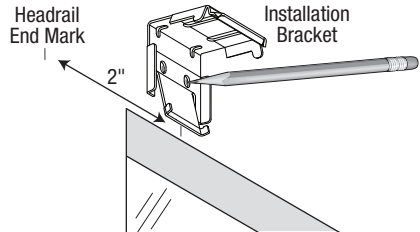

IMPORTANT: The brackets should be level and aligned.

CAUTION: The rear of the brackets must be flush against a flat mounting surface. Do not mount brackets on curved molding.

- Extension brackets provide up to 1¹/₂" of clearance. If used, center the brackets on your marks and mark the screw holes.
- Drill the screw holes using a ³/₃₂" drill bit.

IMPORTANT: Use drywall anchors when mounting into drywall.

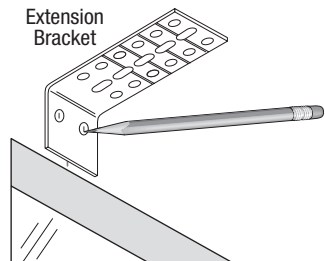

INSTALLATION

- Attach the installation/extension brackets using the screws provided.

CAUTION: The rear of the installation brackets must be flush against a flat mounting surface. Do not mount installation brackets on curved molding.

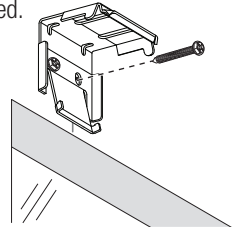

- When using extension brackets, attach the installation brackets using the screws and speed nuts provided.

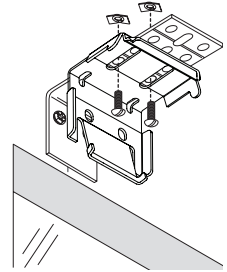

Install the Shade

- With the headrail slightly tilted, insert the front lip of the headrail onto the front lip of the installation bracket.
- Push the headrail back and up until its bottom lip snaps into bottom tab on the installation bracket.

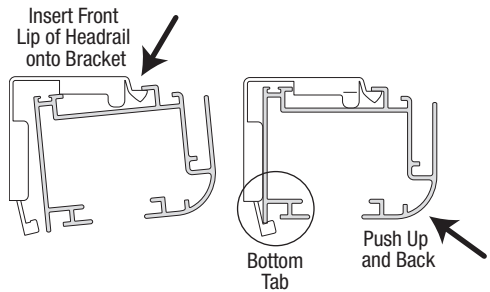

Attach the Optional Components

If You Ordered Valance Returns for a Standard Valance...

- Remove the paper from the pressure sensitive tape on the valance returns and headrail end caps.
- Attach the return to the valance, smoothing the valance along the tape.

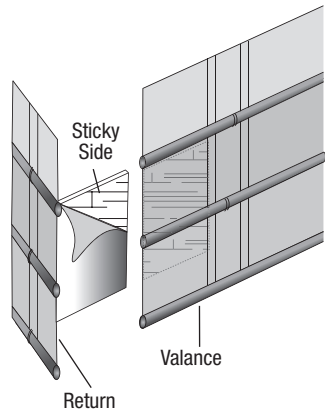

If You Ordered Crestover™ Valance...

Assemble the Valance (Using Dovetail Corner Clips) — Outside Mount Only

- Slide the two dovetail clips attached to the wood valance face into the corresponding grooves on the valance returns.

NOTE: If the returns are too long, they can be shortened using a cut-off saw to remove material from the back edge. Do not cut the miter corners to shorten the returns.

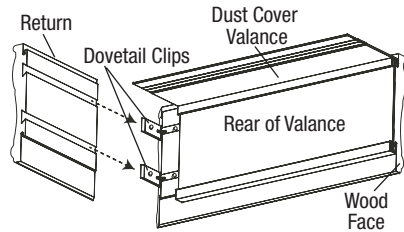

Mount the Crestover™ Valance

- Place the hook on the valance bracket into the top groove on the bracket attached to the headrail.
- Rotate the valance down until the white tabs contact the headrail brackets. Push the valance until the tabs lock in place. You will hear a click when each bracket is securely in place.

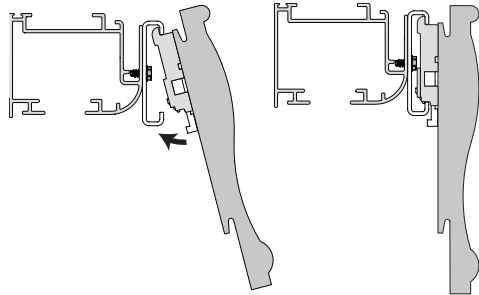

INSTALLATION

If you ordered Hold-Down Brackets...

Hold-down brackets provide stability and prevent swaying by securing the bottom rail — for example, in French door applications. Hold-down brackets can only be used with outside mount shades.

- Lower the shade and place the pins from the hold-down brackets into the bottom rail end caps.
- On the mounting surface, mark the screw holes.
- Drill the screw holes using a $\frac{3}{32}$ " drill bit.
- Attach the hold-down brackets to the mounting surface using the screws provided.

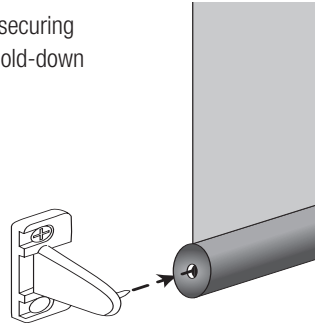

Attach the Universal Cord Tensioner — EasyRise™ Only

Before you proceed, you must first slide the cord tensioner to the bottom of the cord loop.

- Insert a small screwdriver, punch, or awl through the screw hole at the bottom of the cord tensioner.
- Move the screw hole down to the indicator line to release the safety mechanism.
- Slide the cord tensioner down to the bottom of the cord loop.
- Attach the cord tensioner according to the instructions provided with the *Universal Cord Tensioner Installation Kit*.

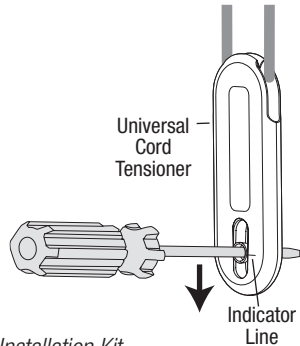

WARNING: It is imperative that the cord tensioner be properly secured to the wall or window frame to reduce children's access to the cord loop. Young children can strangle in cord loops. They can also wrap cords around their necks and strangle.

CAUTION: EasyRise™ shades will not operate properly unless the cord tensioner is secured. A *Universal Cord Tensioner Installation Kit* has been included with your shade. Follow the instructions in the kit to correctly secure the cord tensioner.

Operate the Shade

IMPORTANT: Top-Down/Bottom-Up and Independent Operable Liner shades have two lift cords. To operate Top-Down/Bottom-Up shades, the right cord operates the middle rail and the left cord operates the bottom rail. You must first lower the bottom rail before lowering the middle rail. Likewise, you must first raise the middle rail before raising the bottom rail.

EasyRise™ Shades

To Lower the Shade

- Pull down on the back of the continuous cord loop.

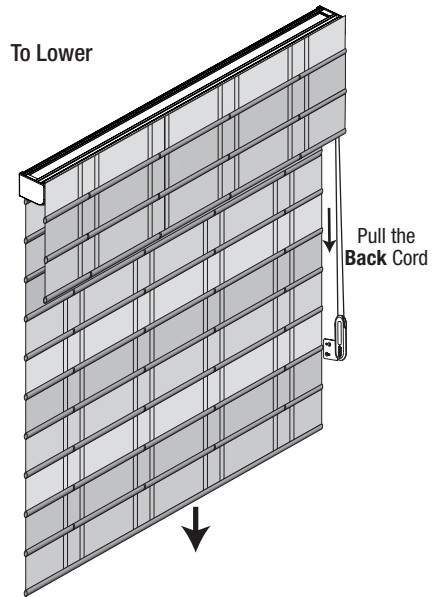

To Raise the Shade

- Pull down on the front of the continuous cord loop.

IMPORTANT: If the cord tensioner moves up the cord, you have not secured it to the wall or window frame. You must do so for the shade to operate properly. See the instructions included with your *Universal Cord Tensioner Installation Kit*.

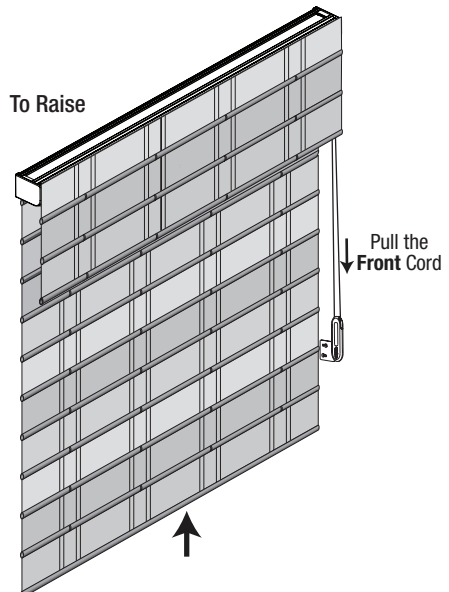

OPERATION

UltraGlide® Shades

For smooth operation, keep the cord close to the fabric when lowering and raising the shade.

To Lower the Shade

- Pull the cord toward the center of the shade at about a 45° angle. A locking mechanism at the top of the cord releases with a “click.” The shade lowers as you allow the cord to return to the vertical position.
- To stop the shade while lowering, move the cord back toward the vertical position and give a slight downward pull, until the locking mechanism engages.
- If the shade hits an obstruction as it is lowered, it will stop. When this happens, the cords in each cord rout may become misaligned. This may cause the shade to be angled or tilted when fully raised. If this occurs, do the following:
 - Raise the shade slightly.
 - Lower the shade completely to the sill. In some cases, pull gently on the bottom rail to get it to drop completely.

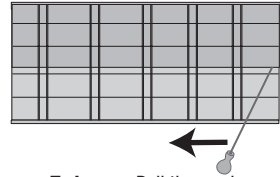

To Lower: Pull the cord toward the center of the shade and release.

IMPORTANT: If the bottom of the shade is tilted when fully raised, do not pull harder on the cord. It does not correct the tilt and may make it worse.

To Raise the Shade

- Pull the cord straight down.
- With each stroke the shade partially raises.
- Allow the cord to retract after each downward stroke.
- Use multiple strokes until the shade reaches the desired position.

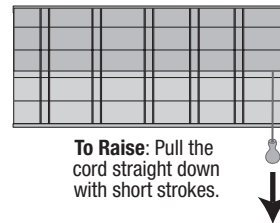

To Raise: Pull the cord straight down with short strokes.

LiteRise® Shades

For better support and smoother operation, use the handle when raising and lowering the shade.

To Raise the Shade

- Slowly and steadily push up on the bottom rail handle. Allow the shade to stack evenly.

To Lower the Shade

- Slowly and steadily pull down on the bottom rail handle.

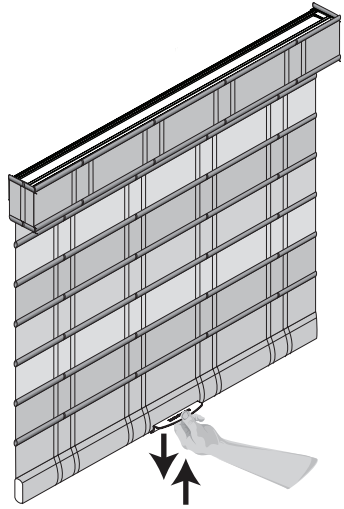

Independent Operable Liner with PowerView™ Motorization

For operation instructions for independently operable liners with PowerView™ Motorization, please refer to one of the following:

- Provenance® Woven Wood Shades with PowerView Motorization Installation, Operation, and Care Instructions
- PowerView Remote Control Guide
- PowerView Scene Controller Guide

Troubleshooting

Problem	The shade will not fit into the installation brackets.
Solution	<p>Check that the installation brackets are level and aligned. Shim the installation brackets to level the headrail, if necessary. Shims are provided.</p> <p>Be sure the heads of the screws are flush against the installation bracket.</p> <p>Check that the headrail is completely inserted into the installation brackets. See “Install the Shade” on page 8.</p>
Problem	The shade is hard to raise or lower, or will not raise or lower.
Solution	<p>Make sure that the shade fabric is not caught between the installation bracket and the headrail.</p> <p>Check that the headrail and installation brackets are level and aligned. Shim the installation brackets to level the headrail, if necessary.</p> <p>If hold-down brackets are used, make sure they have been released before operating the shade.</p>
Problem	The shade raises or lowers unevenly or the bottom rail is uneven when fully raised.
Solution	<p>Check that the headrail and installation brackets are level and aligned. Shim the installation brackets to level the headrail, if necessary.</p> <p>Check to see if there is an obstruction in the shade’s path. If a shade hits an obstruction as it is lowered, it may become misaligned. This may cause the shade to be angled or tilted when fully raised. Try lowering the shade completely, then raising it to allow it to self-correct.</p>
Problem	The cord tensioner has climbed to the headrail.
Solution	<p>Pull down on the spring to relieve tension and pull the universal cord tensioner to the bottom of the cord loop. Properly mount the cord tensioner. See “Attach the Universal Cord Tensioner — EasyRise™ Only” on page 10 and/or the instructions included with your <i>Universal Cord Tensioner Installation Kit</i>.</p>
Problem	The cord tensioner grabs onto the cord upon operation.
Solution	<p>Check that the universal cord tensioner is mounted properly. Reinstall, if necessary. See “Attach the Universal Cord Tensioner — EasyRise Only” on page 10 and/or the instructions included with your <i>Universal Cord Tensioner Installation Kit</i>.</p>

Removing the Shade (If Necessary)

If you have the Crestover™ valance, remove the Crestover valance (see below) before removing the shade.

- Raise the shade completely.
- Support the headrail so that it does not fall. Push up on the headrail and use your finger or a flat blade screwdriver to release the bottom tab on the installation brackets.
- Pull the headrail straight out from the installation brackets.

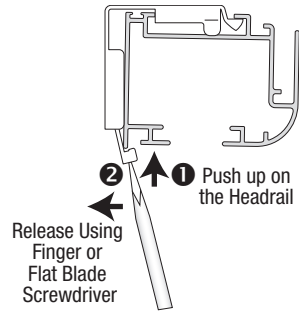

Removing the Crestover Valance (If Necessary)

- **Inside Mount:** Push the white tab at the bottom of the valance bracket to release. Rotate the bottom of the valance away from the shade and remove.

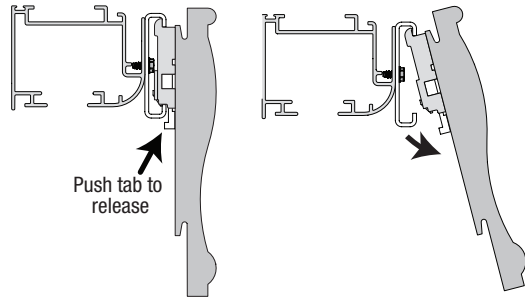

Cleaning Procedures

For most fabrics, the following options are available if your shade needs cleaning.

Dusting

- Regular light dusting with a feather duster is all the cleaning that is needed in most circumstances. You may also use a hair dryer on a cool setting or compressed air set to a low pressure.

Vacuuuming

- Use a low suction, hand-held vacuum for more thorough dust removal.

Spot-Cleaning

Only the following Provenance® fabrics can be spot-cleaned:

- Adelaide
- Aspen
- Brisbane
- Camden
- Coastal
- Colfax
- Corner Market
- Janipur
- Kathay
- Kiawah
- Mindanao
- Montana
- Nantucket™
- Palisade
- Safari
- Samoa
- Shoal Bay
- Thailand
- Mono Color Liners
- Duo Color Liners

- Prepare a solution of warm water and a mild detergent.
- Dampen a clean cloth in the solution and wring it out.
- Dab the spot with the dampened cloth until it is gone. Do not rub the fabric.
- Allow the shade to dry in the completely lowered position.



WARNING

For more safety information call 1-888-501-8364 in the U.S. or 1-866-662-0666 in Canada.

- Young children can STRANGLE in cord loops. They can also wrap cords around their necks and STRANGLE.
- Always keep cords out of the reach of children.
- Move cribs, playpens and other furniture away from cords. Children can climb furniture to get to cords.

Cord Loop Shades

- Attach the cord tensioner on the cord loop to the wall or window casement. This can prevent children from pulling cord loops around their necks. See “Attach The Universal Cord Tensioner (UCT)” on page 10.
- Hunter Douglas provides a cord tensioner installation kit with instructions for attaching the cord tensioner. For the shade to operate properly, the cord tensioner must be correctly mounted and secured.
- Fasteners provided in this kit may not be appropriate for all mounting surfaces. Use appropriate anchors for mounting surface conditions.
- Only Hunter Douglas supplied cord tensioners and hardware should be used. Replacement parts may be obtained by contacting the Hunter Douglas Customer Information Center at 1-888-501-8364.



NOTE: The warning labels on the bottom rails of corded window coverings contain important safety information. These warning labels are designed to be permanent, in accordance with the industry's safety standards, and must not be removed.