

How to Install Custom Metal Blinds – Box Bracket

Before you begin your installation:

READ ALL INSTALLATION INSTRUCTIONS!

- Make sure that you have all tools and hardware needed for installation.
- Check the installation surface (wall, ceiling, or window frame) to ensure that you have suitable fasteners and tools for the material.
- Double check the headrail and blinds for proper width and length. If you are installing several sets of blinds, be sure to match them with the appropriate window.
- Check the parts list shipped with the product to confirm that you have the correct number of brackets.

TOOLS YOU MAY NEED (NOT INCLUDED):

- Tape Measure
- Level
- Pencil
- 3/8" Wrench
- Flat-blade or Philips Head Screwdriver
- 1/4" Nutdriver
- Drill with Bits
- Drywall Anchors
- Scissors or Utility Knife
- Safety Glasses
- Ladder

STEP 1

Mounting Brackets

There are different types of brackets used with box bracket installations. Bracket appearance may vary depending on size.

Preparing box brackets for installation:

Open the front of the bracket by pressing on the bottom of the bracket to release the locking tab while lifting the front gate.

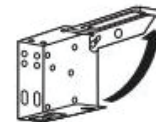
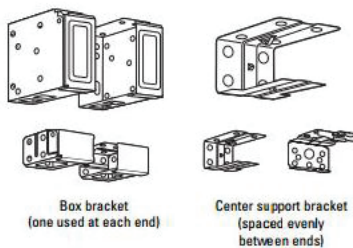

STEP 2

Optional extension brackets

If your blinds include optional extension brackets, temporarily assemble them to the mounting brackets at this time. You will need to use the extension brackets to determine mounting hole locations in Steps 3 and 4.

Refer to the included instructions for your style of extension brackets.

STEP 3A

Mark the bracket locations — outside mount installation

- Position the box brackets at each end of the headrail.
- When using a single center support bracket, center it between the box brackets. For more than one center support bracket, space the support brackets evenly, not more than 30" apart. Making sure the brackets will not interfere with the cord mechanism or any other internal parts.
- Mark the bracket mounting hole locations, making sure they are square and equally spaced. For outside-mount installations, use a spirit level to check for levelness.

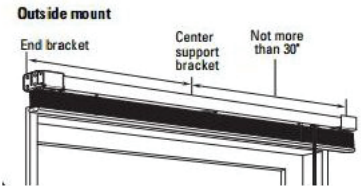

STEP 4A

Install the brackets — outside mount installation

Example: Installation in drywall using drywall anchors and included screws. Use two screws per bracket.

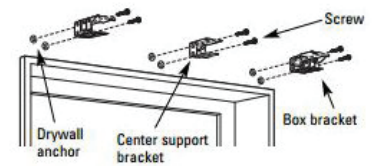

STEP 3B

Mark the bracket locations — inside mount installation

- Position the box brackets at each end of the headrail. Depending on the installation location, box brackets can be attached using the top, back, or the side holes.
- When using a single center support bracket, center it between the box brackets. For more than one center support bracket, space the support brackets evenly, not more than 30" apart. Making sure the brackets will not interfere with the cord mechanism or any other internal parts.
- Mark the location of the desired bracket mounting holes, making sure they are square and equally spaced.

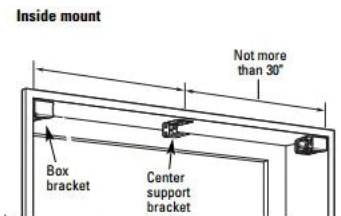

STEP 4B

Install the brackets — inside mount installation

Example: Installation in a wood window frame using the included screws. Use two screws per bracket. Depending on the installation location, box brackets can be attached using the top, back, or the side holes.

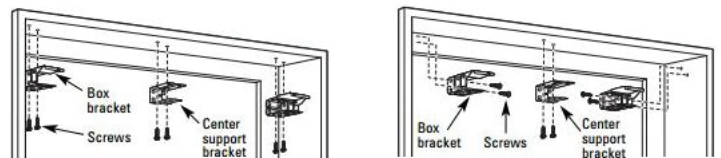

STEP 5

Attach Valance

- Attach the valance clips on the front of the headrail, one at each end. Space any remaining clips evenly.
- Hook the valance into the clips



STEP 6

Attaching the headrail to the mounting brackets

- Align the headrail, tilt mechanism facing out, with the center support brackets and box brackets.
- Being careful not to trap the top slat in the brackets, slide the headrail straight back until it is snug in the center support brackets.
- If the headrail can slide from side to side in the box brackets, use a flat-head screwdriver to bend out the tabs on the ends of the headrail until it is snug.

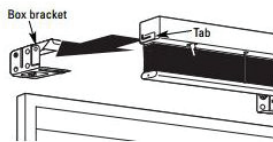

- Lower the front of each box bracket and press until the locking tab clicks into place.

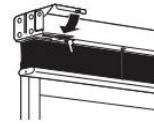

- For blinds using center support brackets with locking tabs, make sure the tab on the bracket is hooked under the lip on the headrail, then press the locking tab until it clicks into place.



STEP 7

Attach the tilt wand

- Remove the protective rubber cap from the tilt mechanism on the headrail.
- Slide the wand sleeve onto the tilter stem and fit the flat end of the S-hook into the tilter stem.
- Hook the end of the tilt wand onto the S-hook and pull down the sleeve on the tilt mechanism.
- Rotate the tilt wand in each direction to ensure proper operation.

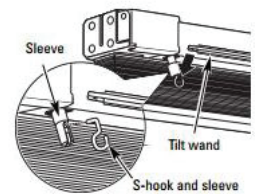

STEP 8

Attach optional hold-down brackets (on some styles)

Type 1 — One-Piece Hold-Down Brackets

- With the hold-down brackets attached to the bottom rail, lower the blinds to the hold-down bracket mounting surface and mark the bracket locations.
- Attach the hold-down brackets at the bottom of the window with the included screws, as shown for your installation type.
- To attach the bottom rail, gently pull the brackets out slightly and insert the pins into the holes on the bottom rail of the blinds.

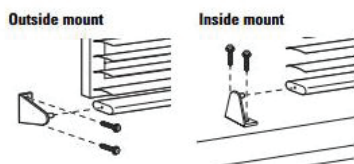

Type 2 — Two-Piece Hold-Down Brackets

- Clip the rounded end of the hold-down pins into the hole at each end of the bottom rail. The other end will hook into the hold-down brackets.
- **NOTE:** Some styles may have the hold-down pins built into the bottom rail.
- With the hold-down brackets attached to the bottom rail, lower the blinds to the hold-down bracket mounting surface and mark the location of the bracket.
- Attach the hold-down brackets at the bottom of the window with the included screws, as shown for your installation type.
- Attach the bottom rail hold-down pins to the bracket.

