

Express Basics Alternative Wood Blinds



WHY CHOOSE EXPRESS BASICS?

Offering the ultimate solution to privacy, light control, and child safety, tap into popular textures and stains that mimic the look and feel of wood for seamless function and classic style with Express Basics Alternative Wood Blinds.

Explore six popular finishes in 2" slat size, including solids, textures, and wood grains.

KEY FEATURES

Expanded Color Options

Sleek Profile

Cordless Lift with Balanced Spring Motor for Enhanced Safety

Increased Privacy and Light Control

Easy to Mount

Backed by our Lifetime Guarantee



| Color Options

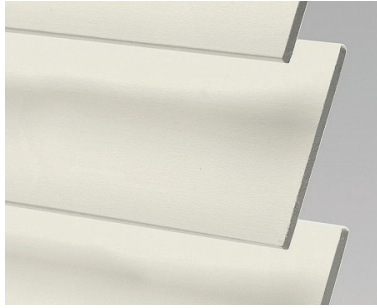

Lily



Textured Lily

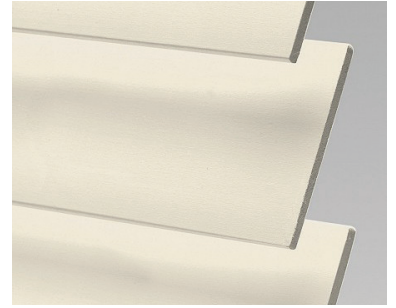

Greek Villa

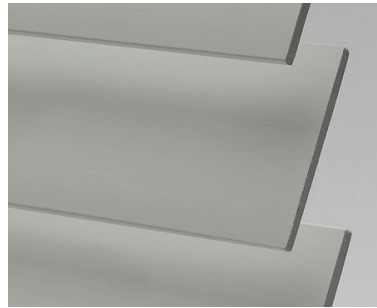

Gravel



Pecan Pie



Walnut Grove

Express Basics Alternative Wood Blinds

Express Basics Alternative Wood Blinds - Cordless Lift

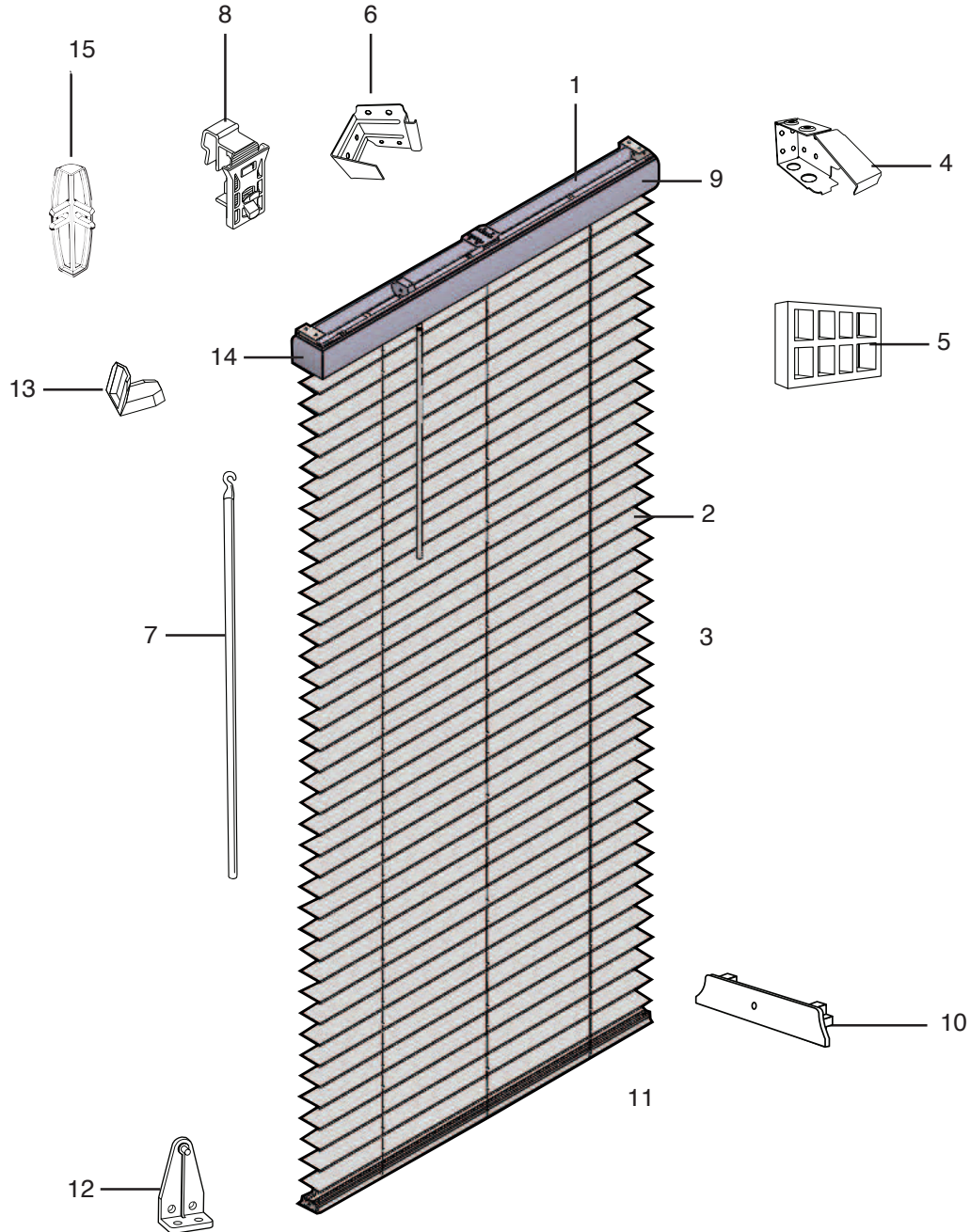

STANDARD PARTS

- | | | |
|--|------------------------------|------------------------|
| 1. Headrail | 7. Tilt Wand | 14. Return |
| 2. Faux Wood Slat | 8. Valance Clip | 15. Valance Corner Cap |
| 3. Ladder | 9. Valance | |
| 4. Installation Box Bracket Set | 10. Bottomrail End Cap | |
| 5. Spacer Blocks | 11. Bottomrail | |
| 6. Center Support Bracket (not required on all blinds) | 12. Hold Down Bracket Set | |
| | 13. Valance Return Connector | |

Express Basics Alternative Wood Blinds

| Product Specifications

PART 1 - GENERAL

1. SUMMARY

- a. Section Includes:
- b. Hunter Douglas Express Basics 2 inch Fauxwood Blinds

2. REFERENCES

- a. FLAME-RESISTANT MATERIALS SHALL PASS OR EXCEED ONE OR MORE OF THE FOLLOWING TESTS:
 - i. National Fire Protection Association (NFPA) 701 (small scale for horizontal applications)
 - ii. Department of Transportation Motor Vehicle Safety Standard 302 Flammability of Interior Materials
 - iii. California Administrative Code Title 19
 - iv. Federal Standard 191 Method 5903 (used by Port Authority of New York and New Jersey for drapery, curtain, and upholstery material)
 - v. Boston Fire Department Test BFD IX-1
 - vi. New York State Uniform Fire Prevention and Building Code
- b. GREENGUARD Gold Certified

3. QUALITY ASSURANCE:

- a. Supplier: Manufacturer, subsidiary or licensed agent shall be approved to supply the products specified, and to honor any claims against product presented in accordance with warranty
- b. INSTALLER: Installer or agent shall be qualified to install specified products by prior experience, demonstrated performance and acceptance of requirements of manufacturer, subsidiary, or licensed agent. Installer shall be responsible for an acceptable installation.

- 4. **UNIFORMITY:** Provide 2 inch Horizontal Fauxwood Blinds of only one manufacturer for entire project.

5. DELIVERY, STORAGE AND HANDLING:

- a. Product shall be delivered to site in manufacturer's original packaging.
- b. Product shall be handled and stored to prevent damage to materials, finishes and operating mechanisms.

6. JOB CONDITIONS:

- a. Prior to shade installation, building shall be enclosed.
- b. Interior temperature shall be maintained between 60° F. and 90° F. during and after installation; relative humidity shall not exceed 80%. Wet work shall be complete and dry.

7. SHOP DRAWINGS:

- a. Show fabrication and installation details for window treatments.

8. SAMPLES FOR SELECTION:

- a. For each color and texture specified, submit 2 sets of samples representing manufacturer's standard range of finishes for aluminum slats at 6 inches (152 mm) long.
- b. Include Samples of accessories involving color selection.
- c. Window treatments Schedule: Use same designations indicated on Drawings.

9. INFORMATIONAL SUBMITTALS

- a. PRODUCT DATA: Manufacturer's descriptive literature shall be submitted indicating materials, finishes, construction and installation instructions and verifying that product meets requirements specified. Manufacturer's recommendations for maintenance and cleaning shall be included.
- b. DRAWINGS AND DIAGRAMS: Wiring diagrams of any motorized components or units, working and assembly drawings shall be supplied as requested.
- c. SAMPLE: Responsible contracting officer or agent shall supply one sample shade of each type specified in this contract for approval. Supplied units shall be furnished complete with all required components, mounting and associated hardware, instructions and warranty.
- d. QUALIFICATION DATA: For Installer.
- e. PRODUCT CERTIFICATES: For each type of window treatments, signed by product manufacturer.
- f. PRODUCT TEST REPORTS: For each type of window treatments, for tests performed by [manufacturer and witnessed by a qualified testing agency] [a qualified testing agency].

10. CLOSEOUT SUBMITTALS

- a. Maintenance Data: For window treatments to include in maintenance manuals.
- b. Sample warranty document

11. MAINTENANCE MATERIAL SUBMITTALS

- a. Furnish extra materials that match products installed and that are packaged with protective covering for storage and identified with labels describing contents.

| Product Specifications

PART 2 - PRODUCTS

1. ACCEPTABLE MANUFACTURER

- A. Hunter Douglas Architectural / 9900 Gidley, CA 91731 / Phone: 800-727-8953 Fax: 800-205-9819/Website: HunterDouglasarchitectural.com.
- B. Product substitutions must be approved by architect minimum of 30 days prior to close of bid.

2. PRODUCT - Express Basics 2 Inch Faux Wood Blind

- A. MATERIALS: Durable engineered polymer material
- B. SIZE SPECIFICATIONS:
 - i. Width: Minimum 18 inches to maximum 96 inches
 - ii. Height: Minimum 18 inches to maximum 84 inches
- C. SLATS: 2 inch faux wood durable engineered polymer
- D. SLAT SUPPORT: Corded, braided ladder spaced to lift slats with the LightsOut routeless privacy feature
- E. HEADRAIL: Low Profile PVC 1-1/2 inch wide by 2-3/8 inch depth head rail with Steel reinforced rod at widths over 60 inches
- F. VALANCE: 2-1/2 inch Crescent Valance with [Mitered Corner, Corner Cap] mounted with valance clip. Inside mount with 1/2 inch return. Outside mount with 3 inch return. Up to 102 inches wide or spliced up to 168 inches wide.
- G. BOTTOM RAIL: 2 inch PVC, routed bottom rail with end cap, optional hold downs
- H. LIFTING MECHANISM: Cordless lift with Balanced Spring Motor
- I. TILTING MECHANISM: Wand tilt at [24 in] or [36 inches] based on height of blind
- J. TILT CONTROL WAND: To be located on the left side only
- K. MOUNTING HARDWARE:
 - i. Box Bracket at 1-3/4 inch height by 2-1/2 inch depth. Support brackets as required by blind width.
- L. FABRICATION:
 - i. Outside Mount: 1/2 inch deduction from headrail, 0 inch deduction from blind width, 1 inch addition to valance
 - ii. Inside Mount: 1/2 inch deduction from headrail, 1/2 inch deduction from blind width, 1/8 inch deduction from valance
- M. FINISHES
 - i. SLAT finish selection from the following: [WHITE, GRAY, GREEK VILLA, TEXTURED LILY, PECAN PIE, BROWN WALNUT]
 - ii. SLAT SUPPORT braided ladders shall be color coordinated with slat

3.INSPECTION:

- A. SUBCONTRACTOR shall be responsible for inspection on-site, approval of mounting surfaces, installation conditions and field measurement for this work.
- B. OTHER INTERACTING TRADES shall receive drawings of shade systems, dimensions, assembly and installation methods from subcontractor upon request.

4. INSTALLATION:

- A. Minimum depth for inside mount is 3/4 inch.
 - B. Product may not be installed near heat sources such as radiators, heat registers, and space heaters which can potentially compromise the integrity of the faux wood material.
 - C. Airflow through the blind must be maintained, product must not be installed behind any material that can reduce the airflow through the slat material.
 - D. Keeping slats closed for long periods of time and/or using additional window treatments in front of or behind the product can significantly increase the temperature the blinds are exposed to.
 - E. Temperatures above 140 degrees Fahrenheit / 60 degrees Celsius may cause the slats to warp or twist and is not permitted at the product installation.
 - F. Install product level, plumb and aligned with adjacent units per installation instructions
 - G. Provide final installation conditions to ensure product is without damage at the time of substantial completion in a dust-free environment
- End of Section 12492