



Smooove® 4 RTS Pure II

Part #1819538

OVERVIEW

The Smooove® 4 RTS Pure II is a multi-channel wall switch designed to control Radio Technology Somfy® (RTS) motorized window coverings. The switch is surface-mounted and battery-powered. Additional frames are available in black and silver (sold separately).

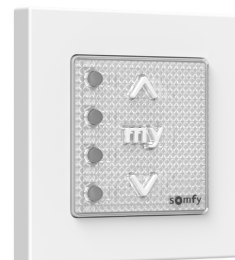

TECHNICAL SPECIFICATIONS

Input	3V
Power Consumption	CR2032 battery
Material	ABS
Protection Rating	IP 20
For interior use only	
Dimensions	3.15" x 3.15" x 0.39" (with frame) & 1.97" x 1.97" x 0.39" (without frame)
Room Range	Operates reliably at 20 feet (up to 65 feet under optimal conditions)
Operating Temperature Range	32°F to 118°F (0°C to 48°C)
Frequency	433.42Mhz
Shipping Weight	1 lb.
CE Rated	
FCC Certified	

FEATURES SUMMARY

- Battery-operated
- Surface-mounted
- LED feedback for ON/OFF button
- ON/OFF button to activate/deactivate front panel
- Multi-channel control for up to 4 window coverings or 4 groups of window coverings
- Black and silver frames sold separately
- Tactile buttons for UP/DOWN/MY/STOP control
- LED illuminates to confirm RTS signal transmission

WHAT'S IN THE BOX

- Smooove® 4 RTS Pure II
- CR2032 battery
- Pure frame
- Mounting plate
- Instructions

OPTIONAL ACCESSORIES

- Smooove Frame, Black 9015023
- Smooove Frame, Silver Matte 9015025
- Smooove Double Frame, Pure 9015238
- Smooove Frame, Pure 9015022

CONNECTIONS AND INDICATORS

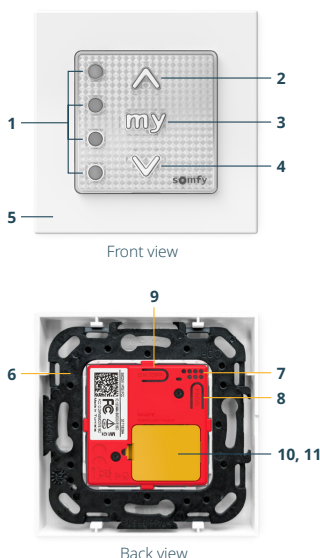

ELEMENT	FUNCTION
1	Channel Selector Button & LED Indicator Selects channel to operate and illuminates to confirm RTS signal transmission
2	UP Button UP directional button
3	MY Button "my" favorite position or STOP button
4	DOWN Button DOWN directional button
5	Interchangeable Frame Pure (included), black and silver available separately
6	Mounting Plate Allows for surface mount
7	LED Feedback GREEN - ON RED - OFF
8	Programming Button Used for RTS programming
9	ON/OFF Button ON/OFF button management (default OFF)
10	Battery Door Protects battery
11	Third-party Battery Uses CR2032 battery

Smooove® 4 RTS Pure II

DIMENSIONS

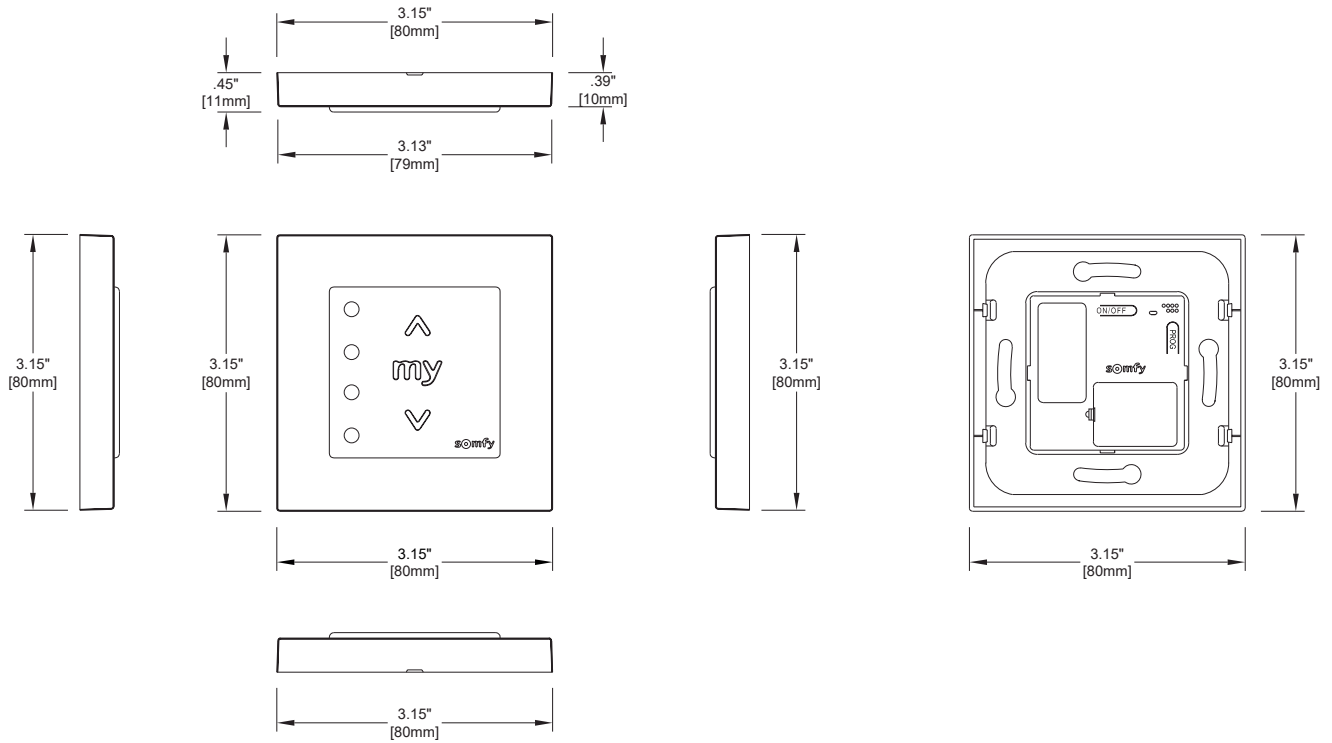

SYSTEM OVERVIEW

The diagram below is meant for illustrative purposes to show the connections from product to product. This device could be used in other configurations than shown below. For specification information on individual products, see related product information.

