

RB Basics

SL20 Clutch Operated Technical Drawing

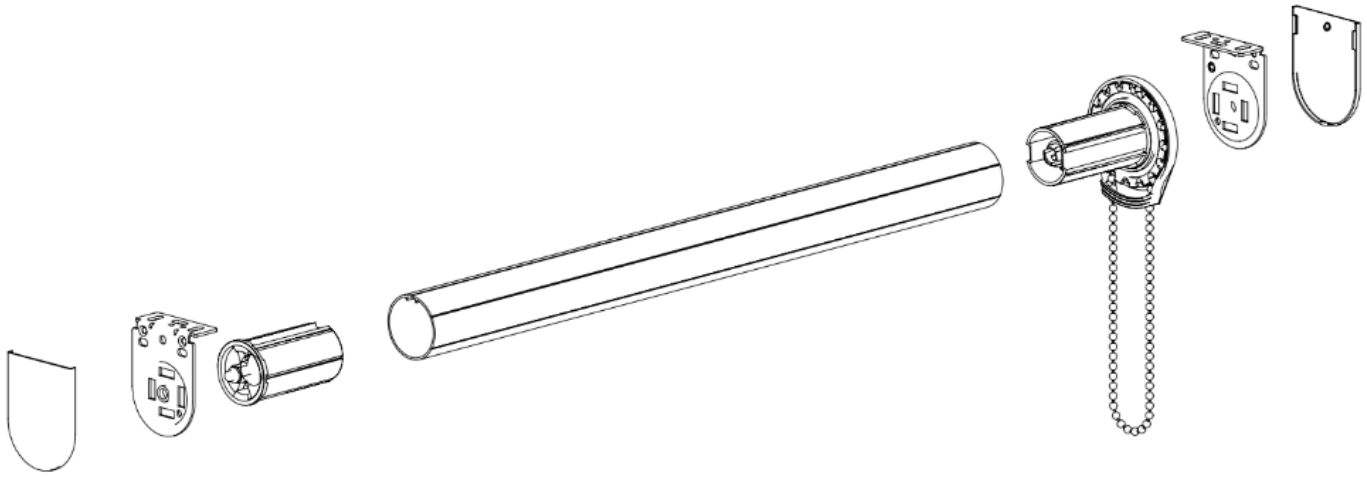

Specifications

Mount	Face, Wall or Ceiling
Tube Sizes	1.5 2.0
Minimum Shade Width	12 in
Lift Capacity	15 lbs
Lift Capacity with Spring Assist	N/A
Fabric Deduction	1.125 in
Chain	Stainless Steel

Chain Breaking Strength	110 lbs
Clutch Colors	White and Black
Bracket Colors	White and Black
Bracket Cover Colors	White and Black
Hembar	Fabric Wrapped Hem Bar Sealed Pocket Exposed Extruded Hem Bar

Inside Mount add 1/8 to fabric deduction
Cloth Measurement is measured width + fabric deduction

Bracket	Dimensions	Max Roll Up
40 mm	2.37H x 2.20W x 0.69D	2.875
55 mm	2.88H x 2.20W x 0.69D	4.375

