

Auto Stop Adjustment

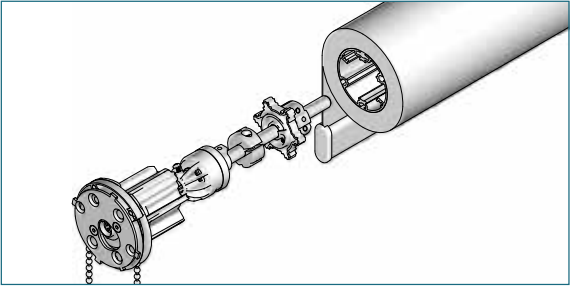

Remove the roller shade. Take out the clutch.

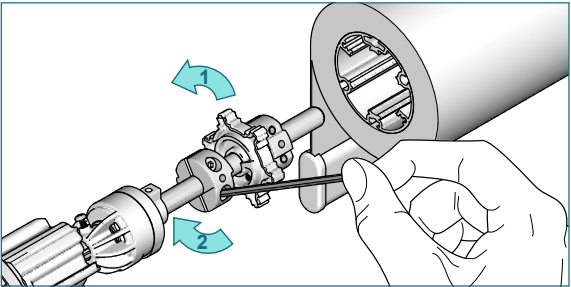

Loosen relevant stopper screws with an Allen key. Lengthen left back and right operated front roll shades by slightly turning and moving the inner stopper towards the clutch (1). Shorten the shade by turning and moving the inner stopper away from the clutch (2).

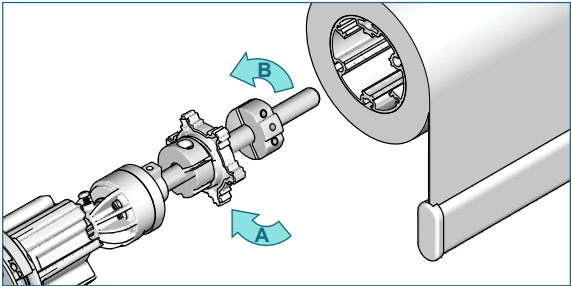

Lengthen right back and left operated front roll shades by slightly turning and moving the outer stopper away from the clutch (A). Shorten the shade by turning and moving the outer stopper towards the clutch (B).

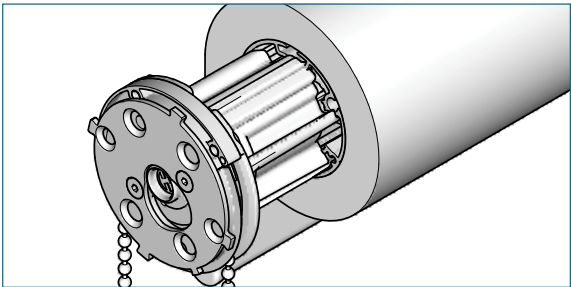

Refasten the screws very tight. Slide the clutch back into the tube.