

# Somfy Connect BMS Interface

Part #1870249



## Overview:

The Somfy Connect™ BMS Interface provides communication between building management systems using BACnet® technologies and Somfy Digital Network™ (SDN) motorized shading systems with or without animeo® IP, Somfy's Total Solar Management System. The BMS interface communicates over IP or the building's wired BMS network to send and receive signals between the building management system and animeo IP or stand-alone SDN systems. When installed, the BMS Interface provides control of individual motors and groups of motors, and when installed in animeo IP systems, control of virtual keypads and feedback from sensors. The Somfy Connect BMS Interface is easily programmable through a web-friendly interface and has integration capabilities for Modbus RTU, Modbus IP, BACnet MS/TP, and BACnet IP.



## Features Summary:

- System control
  - Stand alone SDN – control individual or motor groups.
    - Position (%) – feedback on motors only
    - Position (absolute) – feedback on motors only
    - Intermediate position
    - Up, Stop, and down control
  - animeo IP – control individual or motor groups, sensors, and virtual keypads.
    - Position (%) – feedback on motors only
    - Up, Stop, and down control/commands
    - Priority control
    - Sensor data – provides single direction information to BMS system
- Supports up to 1500 data points.
- Integration capabilities: Modbus, BACnet MS/TP, BACnet IP
- Sensor data – provides single direction information to the BACnet network.
- Programmable through user friendly interface.
- Auto device discovery for animeo IP.

## Technical Specifications:

- 1500 data points maximum
- Input: 9-30 VDC or 12-24 VAC
- Power Consumption: 250 mA
- Material: ABS plastic
- Dimensions: (L x W x H) 4.5 x 3.2 x 1.6 in.
- Operating Temperature Range: F= -40° to 167°
- Relative Humidity: 5-90% RH, non-condensing
- Shipping Weight: 1 Lb.
- Approvals:
  - BACnet Testing Labs (BTL) B-ASC Ver. 12
  - TUV approved to UL 916 EN 60950-1, EN 50491-3 and CSA C22-2 standards
  - RoHS Compliant
  - DNP3 Conformance Tested
  - CE & FCC Approved
  - BTL Marked Certified

## What's in the Box:

- (1) 24V DC 1.66A Wall Mount Power Supply (Cat. No. 1822209)
- BACnet device quick guide (in-depth instructions online)

## Optional Accessories:

- Bus Power Supply (Cat. No. 1822440)
- Data Hub

## Connections and Indicators:

CONNECTIONS	FUNCTION
1 Field	BACnet MS/TP and Modbus connection Screw terminal
2 Ethernet Port	Local area network configuration connection between BACnet IP and animeo IP using an RJ45 connection port
3 Host	Stand alone SDN or URTSI connection Screw terminal
4 Power	9-30V DC or 12-24V AC Screw terminal

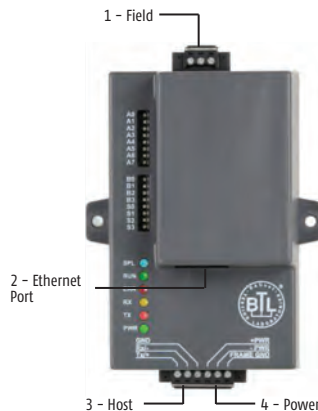

TAG	LED INDICATORS
SPL	Not used
RUN	Once powered, wait 20 seconds and the green LED will begin to flash to indicate normal operation.
ERR	A solid red light indicates a system error on the interface.
RX	Stand alone SDN communication status
TX	Stand alone SDN communication status
PWR	Solid green at all times
RTC	Unused

## Cable Pinouts:

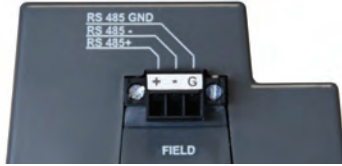

RJ45 Pinout

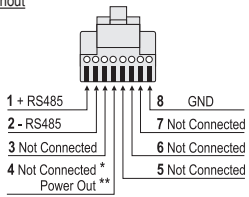

## Dimensions:

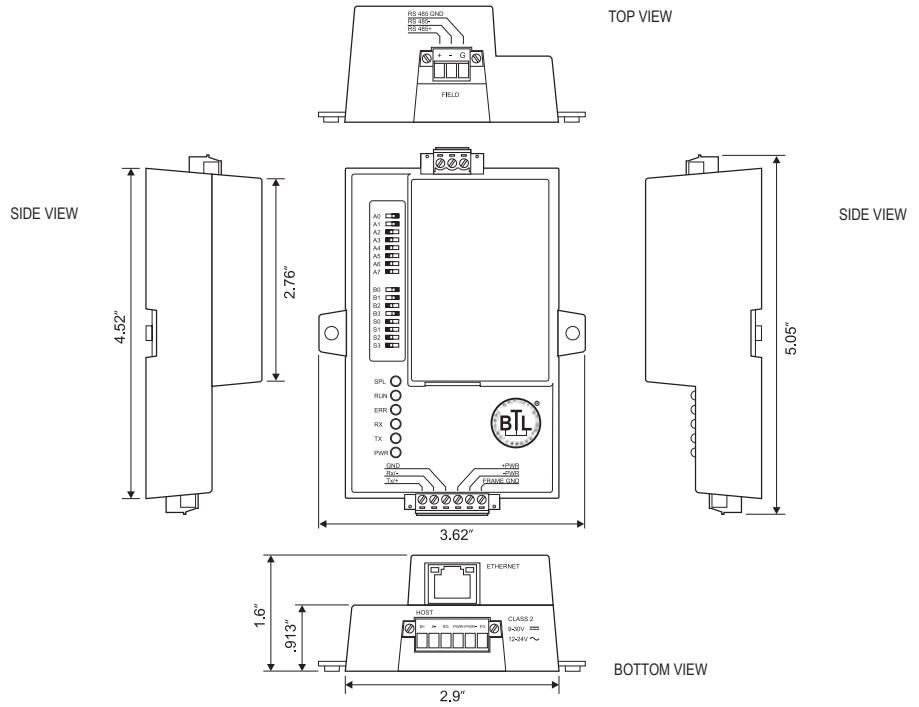

## Wiring Best Practices:

### animeo IP

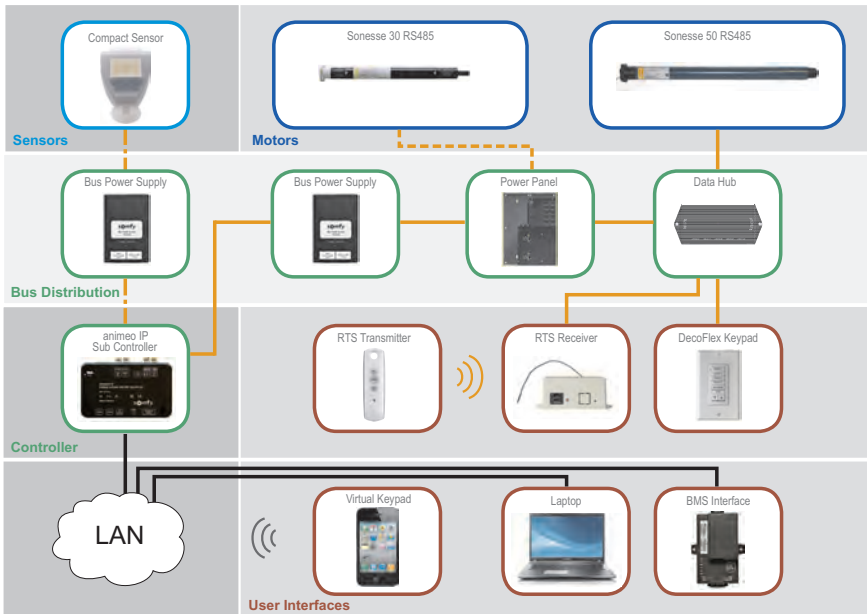

#### Component Types

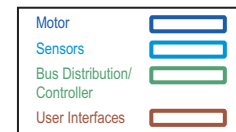

### Standalone SDN

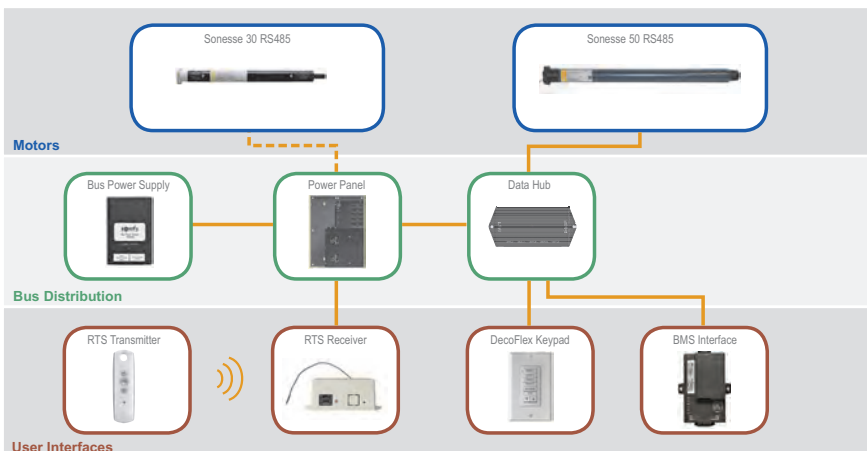

#### Wiring Connection Types

