

Installation Instructions

HunterDouglas 
Architectural



RB 500+ Manual **Roller Shades**

Heavy Duty Clutch and Brackets and
4" Fascia - Outside Mount

Window Coverings

Hunter Douglas Architectural Window Coverings continues to deliver expertly engineered solutions to manage light and glare control.

This booklet provides installation instructions that can be used as a stand alone piece or may accompany video instructions at bit.ly/2vm9z2p

RB 500+ Manual **Roller Shade**

Heavy Duty Clutch and Brackets and
4" Fascia - Outside Mount

HunterDouglas 
Architectural

WARNING/ADVERTENCIA

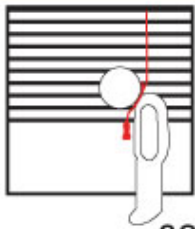

Window Blind Cord Strangulation Risk

Window blinds with a damaged or loose tension device or retractable cord that fails to fully retract pose a strangulation risk to children. To avoid this potential strangulation risk, consider purchasing cordless products or products with inaccessible cords.

Riesgo de Estragulación en Cuerdas de Persianas

Las persianas con un dispositivo tensor suelto o dañado o con una cuerda retráctable que no se ajusta completamente representan un riesgo de estrangulación para los niños. Para evitar un posible riesgo de estrangulamiento, considere comprar productos inalámbricos o productos con cuerdas inaccesibles.

Copyright © 2019 Hunter Douglas Architectural

800-727-8953

HDarchitectural.com

Materials Needed



Laser Level



Measuring Tape



Pencil



Flat Blade and
Philips Screwdrivers



2" Screws #10



Needle Nose Pliers



Power Drill, 5/32" & 1/8"
Drill Bits 5/16" hex driver

Installation Process



Begin by installing the brackets. First, measure and mark the ordered width of the shade inside the window casement. A minimum 4" vertical surface is required to mount the brackets



Place your first bracket in its mounting location and mark the screw holes. Place your second bracket and repeat the process.



Next, pre-drill your screw holes using a 5/32" drill bit. If your shade order did not include a leveler, go ahead and attach the brackets with the provided screws using the 5/16" hex driver.

The brackets should be level and aligned.



If you chose the pre-assembled leveler option, ensure that the opening to access the leveling set screw is pointing downwards before installing the brackets. This is where you will insert the provided Allen Key to adjust skewing.



To adjust, insert the Allen Key into the set screw of the leveler. To lower the shade, turn the Key to the right to rotate the set screw clockwise. To raise the shade, turn the Key to the left to rotate the set screw counter clockwise. All adjustments can be made after the shade has been installed and operation has been tested.

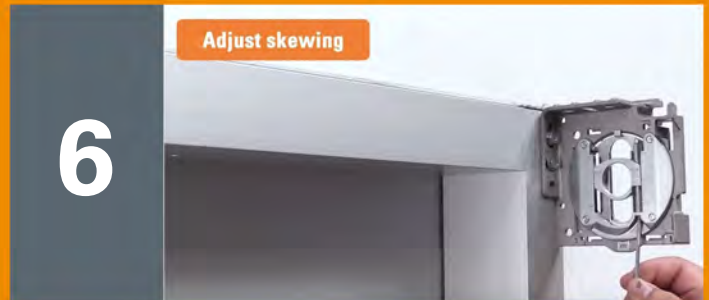

Next, install the clutch end of the shade onto the tab on the clutch-side bracket. The bottom of the clutch should always point straight down. Finally, push the idle end into the shade and place into the idle end bracket.



Secure the shade by turning the locking ring away from the bracket. At this point, the tape band and child safety tag can safely be removed.





Now is a good time to check that the shade is level and aligned and functioning properly. Raise and lower shade to check functionality.

10

Now you're ready to install the cord tensioner. Please review video below.

- [Outside Mount Video](#)

If no further adjustments need to be made, proceed with installing the fascia. Insert the top lip of the fascia into the top insert of the bracket.

11



Rotate the fascia down toward the window, applying pressure until the fascia snaps into place.

12

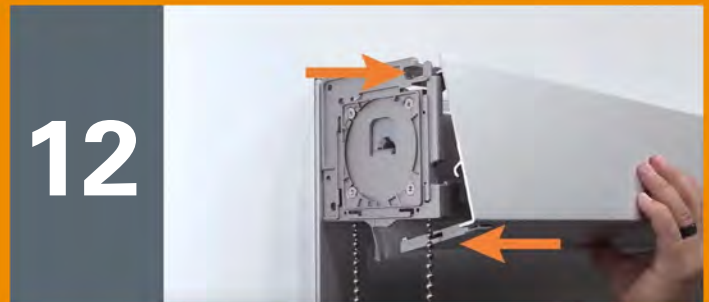

Check to ensure fascia is secure. Note that if bracket covers were not required, the fascia will run the full desired length.

13



If bracket covers were ordered, slide the covers onto the brackets making sure the grooves match up.

14



Check shade functionality one final time!

15



Uninstallation Process



Start by sliding out bracket covers. To remove the fascia, push upward from the bottom of the fascia and pull away from the brackets.



Next, remove the cord tensioner.



Loosen the locking ring by turning it in the direction of the bracket.

Using a flathead screwdriver, push the idle end into the shade. Lower the idle end side to allow removal of the clutch end.



You're now ready to Uninstall the brackets!



Congratulations!

You have now successfully installed and uninstalled an outside mounted RB 500+ Manual Roller Shade with Standard Duty Brackets.