

Installation Instructions

HunterDouglas 
Architectural



RB 500+ Manual **Roller Shades**

with Standard Brackets - Inside Mount

Window Coverings

Hunter Douglas Architectural Window Coverings continues to deliver expertly engineered solutions to manage light and glare control.

This booklet provides installation instructions that can be used as a stand alone piece or may accompany video instructions at bit.ly/2vm9z2p

RB 500+ Manual
Roller Shades
with Standard Brackets - Inside Mount

HunterDouglas 
Architectural

⚠️ WARNING/ADVERTENCIA

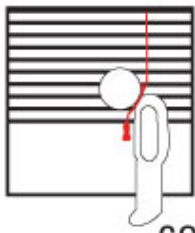

Window Blind Cord Strangulation Risk

Window blinds with a damaged or loose tension device or retractable cord that fails to fully retract pose a strangulation risk to children. To avoid this potential strangulation risk, consider purchasing cordless products or products with inaccessible cords.

Riesgo de Estragulación en Cuerdas de Persianas

Las persianas con un dispositivo tensor suelto o dañado o con una cuerda retráctable que no se ajusta completamente representan un riesgo de estrangulación para los niños. Para evitar un posible riesgo de estrangulación, considere comprar productos inalámbricos o productos con cuerdas inaccesibles.

Copyright © 2019 Hunter Douglas Architectural

800-727-8953

HDarchitectural.com

Materials Needed



Power Drill, 5/32" & 1/8" Drill Bits, 5/16" Hex Driver



Steel Tape



Pencil



Flat Blade and Philips Screwdrivers



2" Screws #10



Needle Nose Pliers



Laser Level

Installation Process



1

First, measure and mark the ordered width of the shade inside the window casement. A minimum 2 1/2" vertical surface is required to mount the brackets.



2

Place your first bracket in its mounting location and mark the screw holes. Place your second bracket and repeat the process.

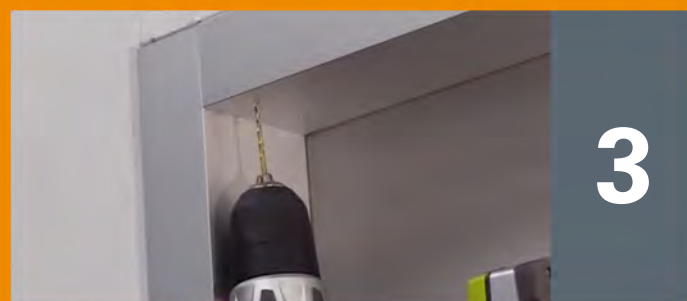

3

Next, pre-drill your screw holes using a 1/8" drill bit.

If your shade order did not include a leveler, go ahead and attach the brackets with the provided screws using the 5/16" hex driver.

4

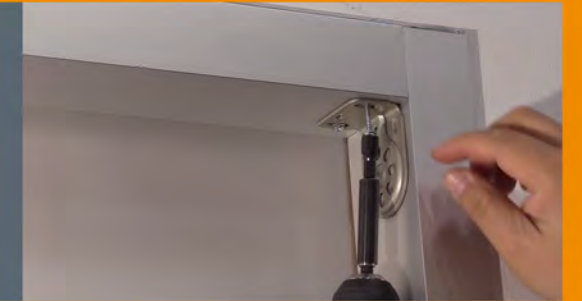

The brackets should be level and aligned.

5



If you've chosen the pre-assembled leveler option, ensure that the opening to access the leveling set screw is pointing downward before installing the brackets. This is where you will insert the provided Allen Key to adjust skewing.

6



To adjust, insert the Allen Key into the set screw of the leveler. To lower the shade, turn the Key to the right to rotate the set screw clockwise. To raise the shade, turn the Key to the left to rotate the set screw counter clockwise.

7

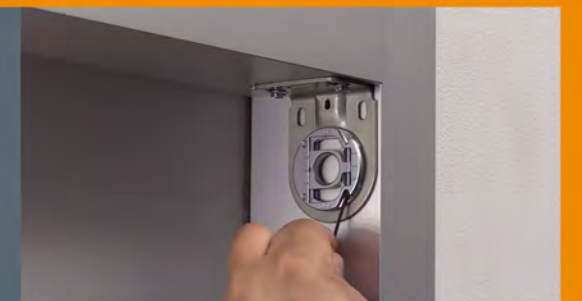

Once the brackets have been mounted you are ready to install your roller shades. Note that the tape around the shade should not be removed until the shade is fully installed.

8



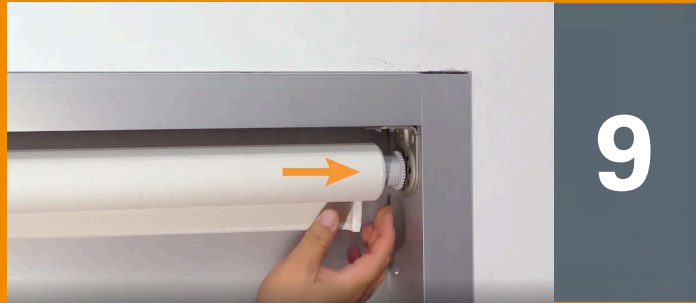

9

Install the clutch end of the shade onto the tab on the clutch-side bracket. The bottom of the clutch should always point straight down. Finally, push the idle end into the shade and place into the idle end bracket



10

Secure the shade by turning the locking ring away from the bracket. At this point, the tape band and child safety tag can safely be removed.



11

Now is a good time to check that the shade is level and aligned.

12

Now it's time to attach the cord tensioner. Please review the videos below:

- Inside Mount Video
- Inside Mount with Bracket Video

UnInstallation Process

1

Start by unscrewing the cord tensioner.

**2**

Loosen the locking ring by turning it in the direction of the bracket.

**3**

Next, using a flat blade screwdriver, push the idle into the shade while pulling the shade towards you. This will allow you to pull the clutch end out of the clutch bracket.

**4**

Finally, remove the screws and brackets.



Congratulations!

You have now successfully installed and uninstalled an outside mounted RB 500+ Manual Roller Shade with Heavy Duty Brackets.