

RB 500 **Heavy Duty+** Clutch - Coupled Shades

SPECIFICATIONS

- Mount:** Face, Wall or Ceiling
- Tube Size:** 50mm (2") and 62mm (2.5")
- Lift Capacity:** 9 lbs
- Lift Capacity with Spring Assist:** 13 lbs
- Minimum Width with Spring Assist:** 35"
- Lift Capacity with Counter Balance System:** 20 lbs
- Minimum Width with Counter Balance System:** 35"
- Light Gap:** Clutch End —1", Middle —1.5", Idle End —.875"
- Chain:** Stainless Steel
- Chain Breaking Strength:** 110 lbs
- Clutch Color:** Grey
- Bracket Color:** Grey
- Bracket Cover Colors:** Black, Grey, & White
- Hembar:** Determined by fabric

Bracket	Dimensions	Max Roll Up
Bracket 55L	3.46"H x 2.56"W x 3.9"D	3.8"
Bracket 75L	3.46"H x 2.56"W x 4.69"D	5.4"

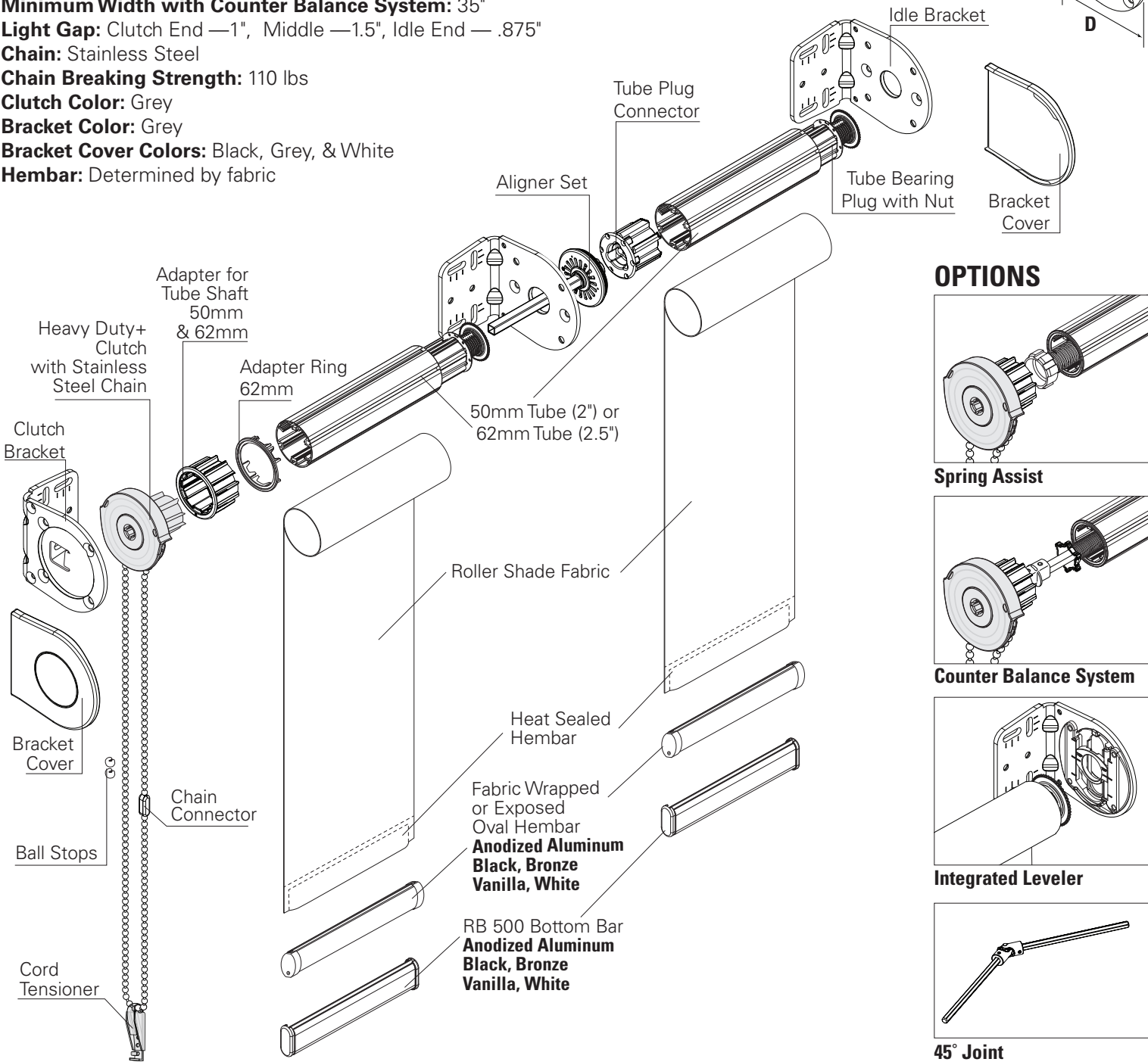
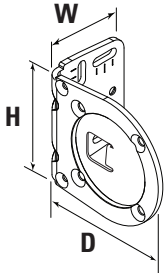

OPTIONS

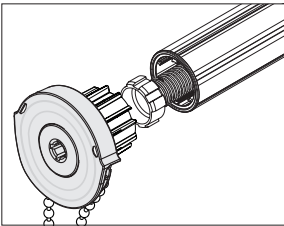

Spring Assist

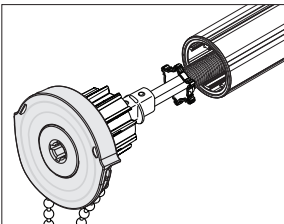

Counter Balance System

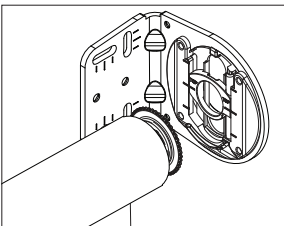

Integrated Leveler

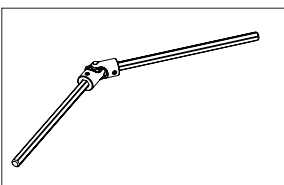

45° Joint