

RB 500+ Heavy Duty Clutch - Coupled Shades

SPECIFICATIONS

Mount: Face, Wall or Ceiling

Tube Size: 50mm (2") and 62mm (2.5")

Lift Capacity: 9 lbs

Lift Capacity with Spring Assist: 13 lbs

Minimum Width with Spring Assist: 35"

Lift Capacity with Counter Balance System: 20 lbs

Minimum Width with Counter Balance System: 35"

Light Gap: Clutch End —1", Middle —1.5", Idle End —.875"

Chain: Stainless Steel

Chain Breaking Strength: 110 lbs

Clutch Color: Grey

Bracket Color: Grey

Bracket Cover Colors: Black, Grey, & White

Hembar: Determined by fabric

Bracket	Dimensions	Max Roll Up
Bracket 55L	3.46"H x 2.56"W x 3.9"D	3.8"
Bracket 75L	3.46"H x 2.56"W x 4.69"D	5.4"

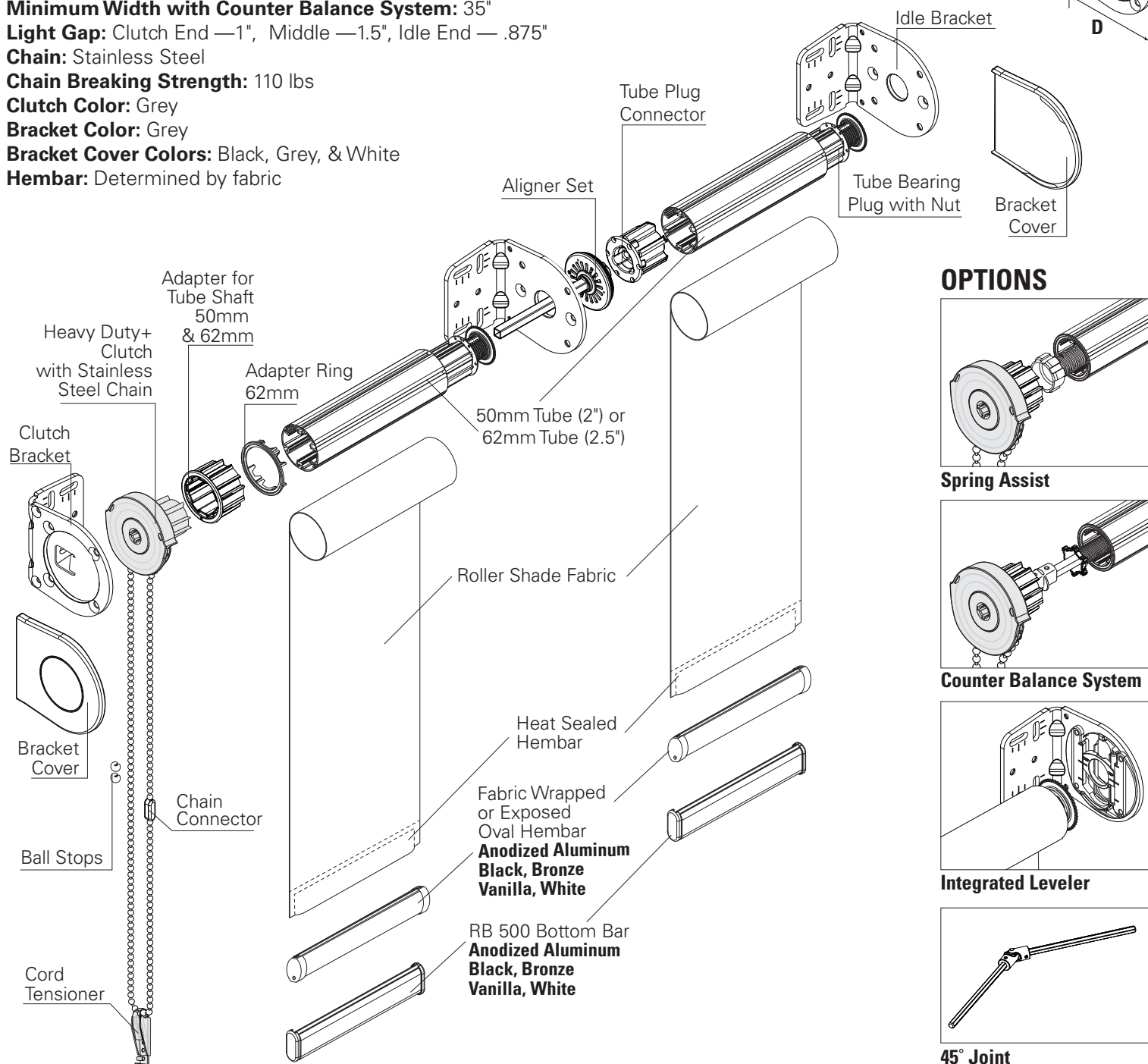
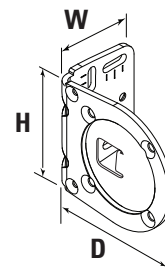

OPTIONS

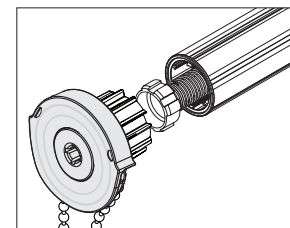

Spring Assist

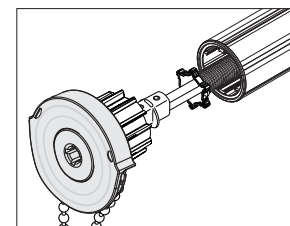

Counter Balance System

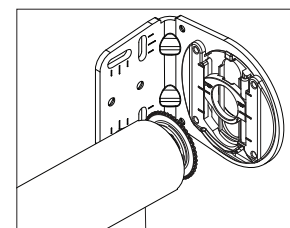

Integrated Leveler

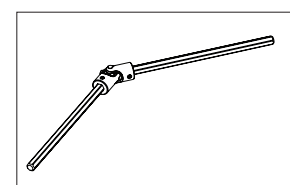

45° Joint