

# RB 500+ Heavy Duty Clutch - Coupled Shades

## SPECIFICATIONS

**Mount:** Face, Wall or Ceiling  
**Tube Size:** 50mm (2") and 62mm (2.5")  
**Lift Capacity:** 9 lbs  
**Lift Capacity with Spring Assist:** 13 lbs  
**Minimum Width with Spring Assist:** 35"  
**Lift Capacity with Counter Balance System:** 20 lbs  
**Minimum Width with Counter Balance System:** 35"  
**Light Gap:** Clutch End —1", Middle —1.5", Idle End —.875"  
**Chain:** Stainless Steel  
**Chain Breaking Strength:** 110 lbs  
**Chain Tensioner Color:** Black, Grey, & White  
**Clutch Color:** Grey  
**Bracket Color:** Grey  
**Bracket Cover Colors:** Black, Grey, & White  
**Hembar:** Determined by fabric

Bracket	Dimensions	Max Roll Up
Bracket 55L	3.46"H x 2.56"W x 3.9"D	3.8"
Bracket 75L	3.46"H x 2.56"W x 4.69"D	5.4"

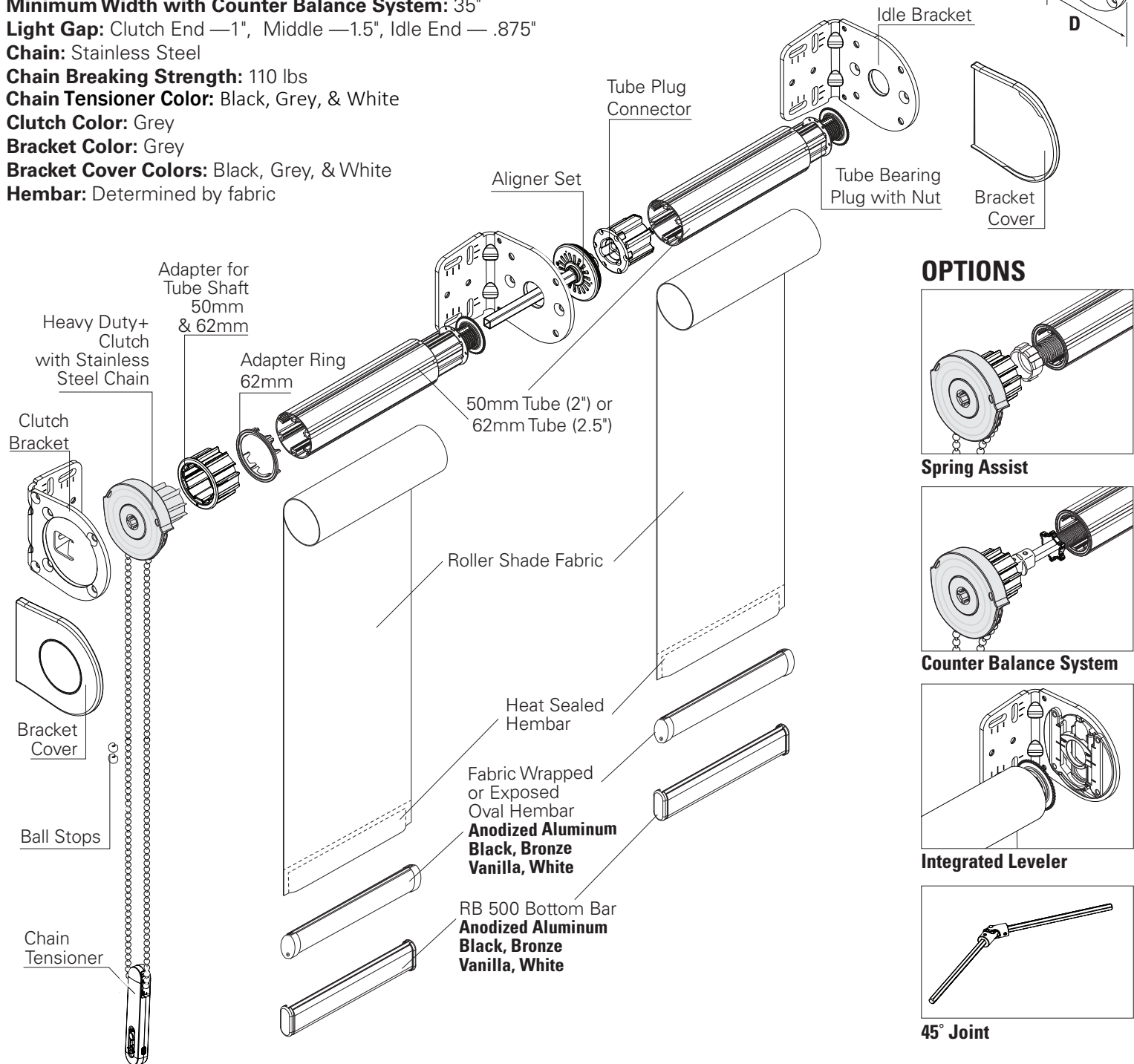
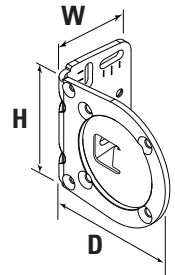

## OPTIONS

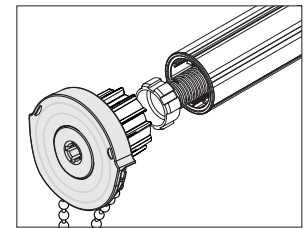

Spring Assist

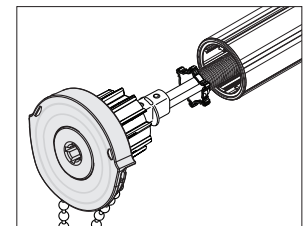

Counter Balance System

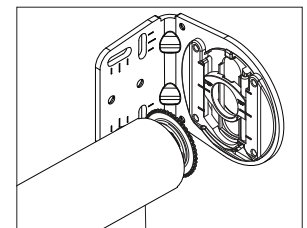

Integrated Leveler

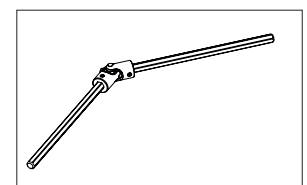

45° Joint