

# RB 500+ Standard Duty 5.25" Dual Pocket

## SPECIFICATIONS

**Mount:** Face, Wall or Ceiling

**Tube Size:** 37mm (1.5")

**Shade Width:** 12" - 80"

**Lift Capacity:** 8 lbs

**Lift Capacity with Spring Assist:** 11 lbs

**Light gap:** Clutch End —7/8" (.875)

Idle End—5/8" (.625)

**Chain:** Stainless Steel

**Chain Breaking Strength:** 110 lbs

**Clutch Color:** Grey

**Bracket Color:** Grey or White

**Bracket Cover Colors:** Grey or White

**Hembar:** Determined by fabric

Bracket	Dimensions	Max Roll Up
5.25" Dual	5.25" H x .125" W x 5.25" D	2-1/2" (2.5")

## POCKET COLORS



White



Aluminum

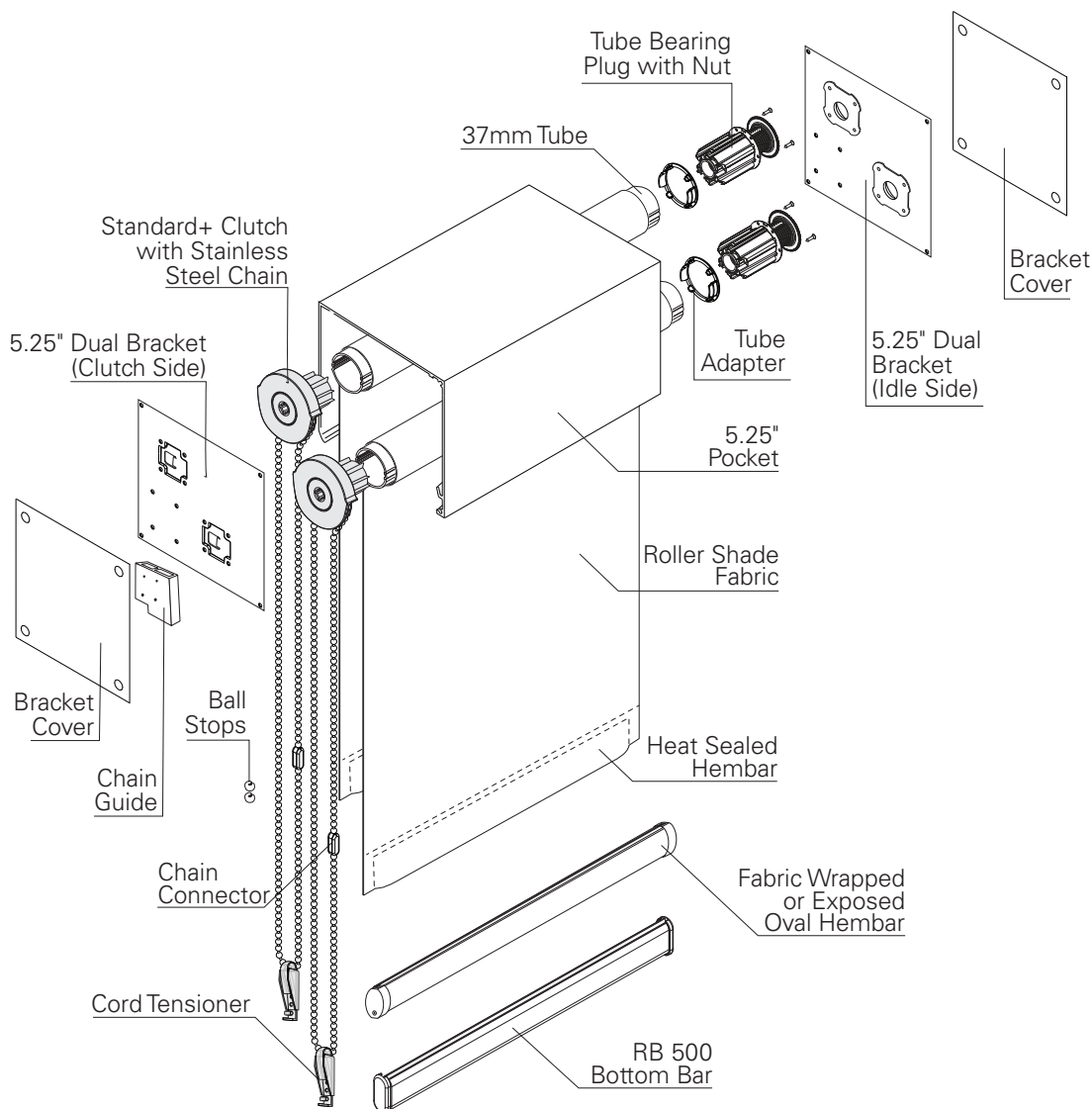
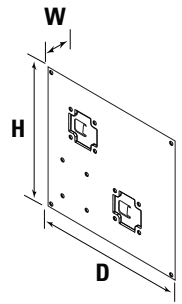

## OPTIONS

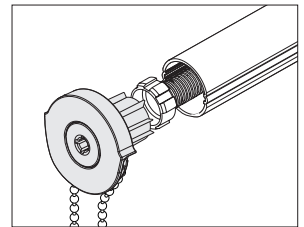

Spring Assist

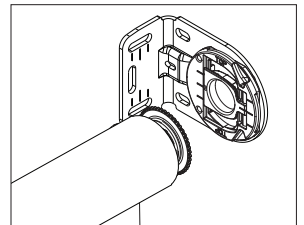

Integrated Leveler

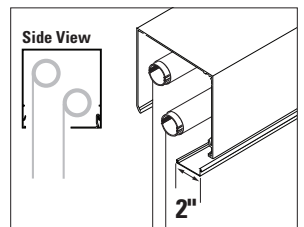

Bottom Closures

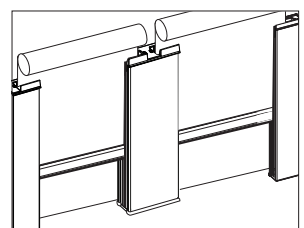

Side and Middle Channel