

# How to Measure TZ100 Zipper Tension System

## Inside Mount

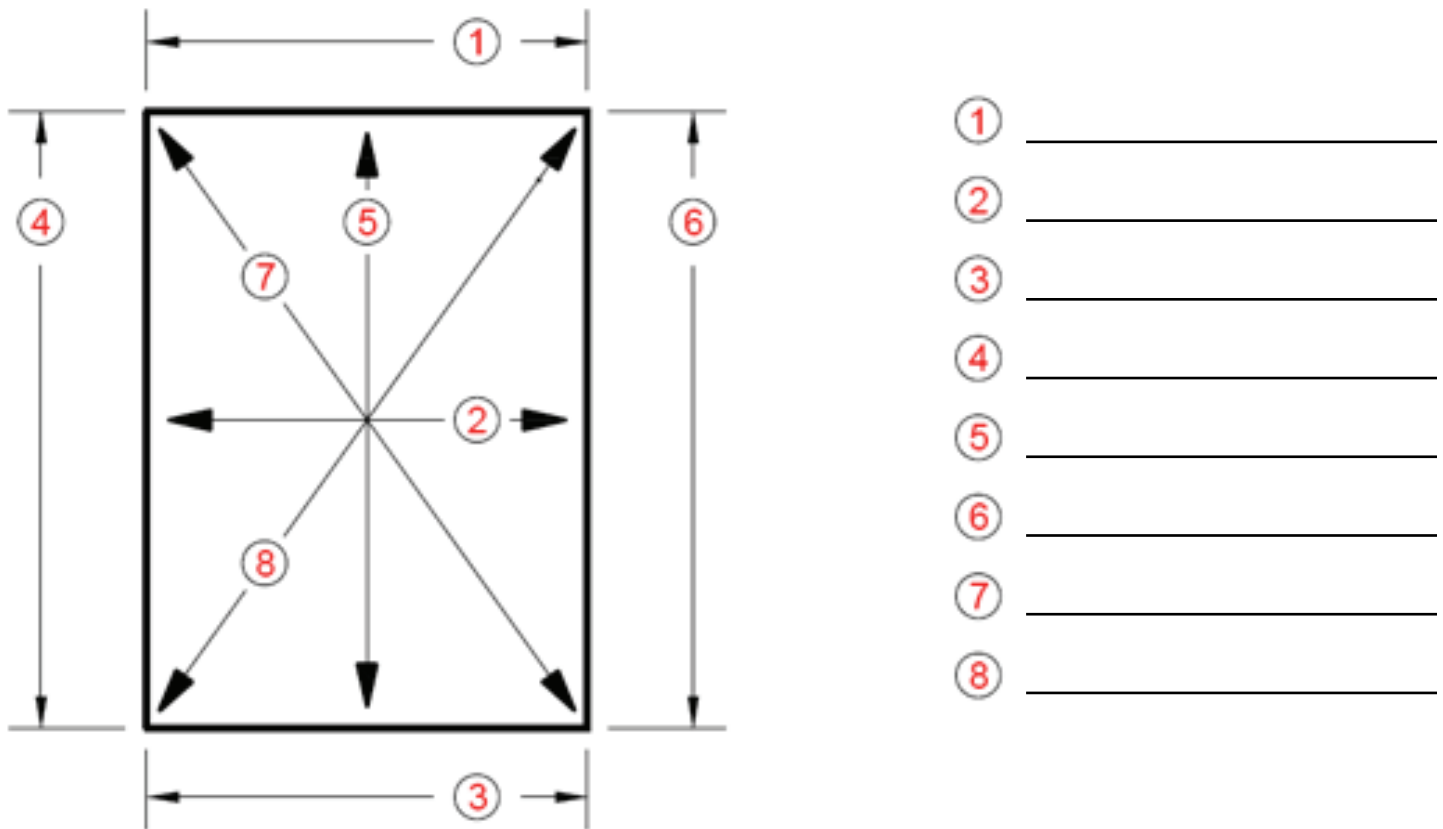

1. Use the Diagram above and the provided entry lines to help keep track of your measurements.
2. Measure the openings width at each end and the center ( ① ② ③ ) where the system will mount. (Confirm you have the smallest dimension for the width)
3. Measure the openings length at each end and the center ( ④ ⑤ ⑥ ) where the system will mount. (Confirm you have the smallest dimension for the length)
4. Measure each diagonal ( ⑦ ⑧ ) dimension of the opening.
5. Order the shade using the following formula to make sure the TZ 100 frame fits in the window opening.

$$\text{System Width} = (\text{Min measured width}) - \frac{(\text{Max diagonal} - \text{Min diagonal})}{2}$$

$$\text{System Length} = (\text{Min measured length}) - \frac{(\text{Max diagonal} - \text{Min diagonal})}{2}$$

# Example

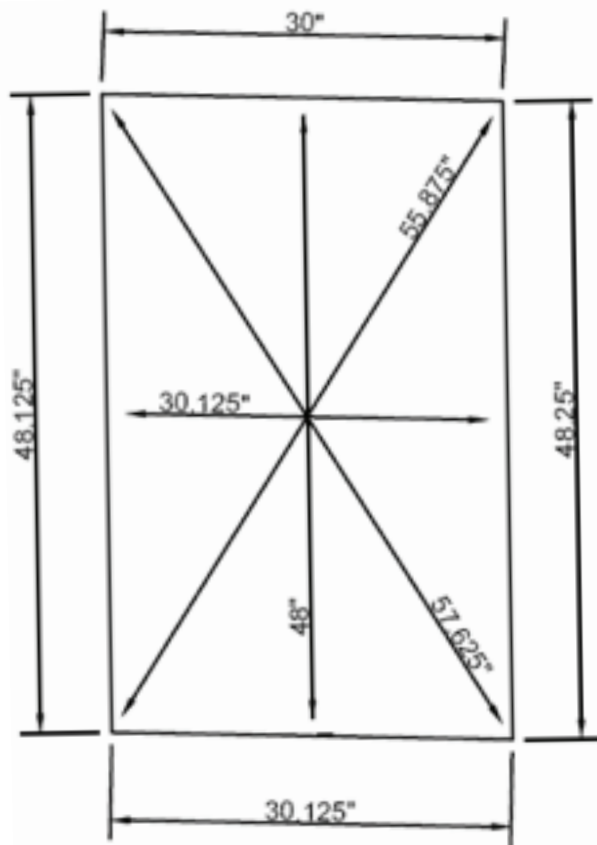

- ① 30"
- ② 30.125"
- ③ 30.125"
- ④ 48.125"
- ⑤ 48"
- ⑥ 48.25"
- ⑦ 57.625"
- ⑧ 55.875"

$$\text{System Width} = (30) - \left( \frac{57.625 - 55.875}{2} \right) = 29.125 \text{ inches}$$

$$\text{System Length} = (48) - \left( \frac{57.625 - 55.875}{2} \right) = 47.125 \text{ inches}$$

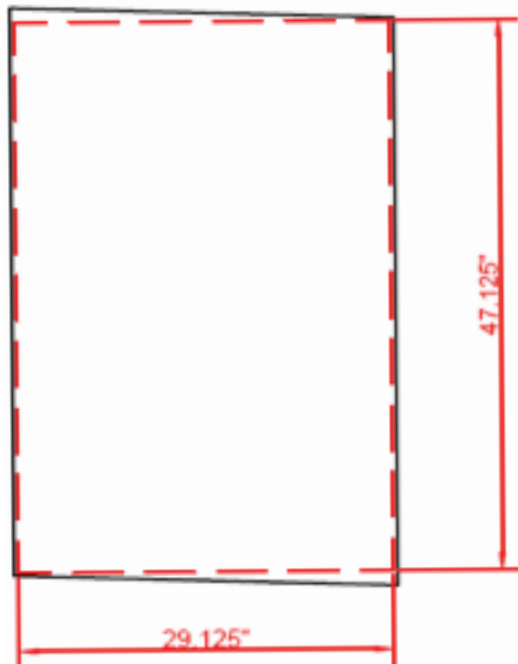

**Black** = Window opening

**Red** = Skylight order size

\*Note how the shade is installed square inside the out of square window opening.