

EverWood® Alternative Wood Blinds



EverWood® Alternative Wood Blinds resist moisture and heat, and are guaranteed against bowing, warping and fading, even in humid areas. EverWood® blinds are made from our proprietary, top-grade, PVC-free polymer.

KEY FEATURES

- GREENGUARD Indoor Air Quality Certified® and GREENGUARD Children and SchoolsSM certified for low-emitting products
- Selection of colors and TruGrain® finishes
- Optional de-Light™ feature delivers privacy and daylight control
- Optional LiteRise® cordless lift system provides added child safety
- Selection of custom valances
- Lifetime Guarantee
- Satisfaction Guarantee against fading, yellowing, warping or bowing



984 Extreme White - Distinctions™	959 Avalanche - Renditions™	971 Arctic Snow - Distinctions™	977 Arctic Snow Textured - Distinctions™	960 Picket Fence - Renditions™	964 Picket Fence Textured - Renditions™	961 Ecru - Renditions™
965 Ecru Textured - Renditions™	962 Journal White - Renditions™	972 Porcelain - Distinctions™	978 Porcelain Textured - Distinctions™	973 Sugar Pine - Distinctions™	970 White Birch - Distinctions™	975 Winter White - Distinctions™
963 Sahara - Renditions™	974 Parchment - Distinctions™	976 French Vanilla - Distinctions™	941 Natural - TruGrain®	985 Desert Sand - Renditions™	986 Golden Brown - Renditions™	940 Maple Toffee - TruGrain®
942 Irish Pine - TruGrain®	935 Distressed Nutmeg - TruGrain®	943 Autumn Oak - TruGrain®	987 Caramel - Renditions™	988 Auburn Clay - Renditions™	936 Mocha - TruGrain®	949 Brandy Wine - TruGrain®
937 Praline - TruGrain®	938 Distressed Praline - TruGrain®	945 English Walnut - TruGrain®	966 Classic Mahogany - TruGrain®			

HunterDouglas 
Architectural

© Copyright Hunter Douglas Contract 2016

® Hunter Douglas and its product names are registered trademarks

® The GREENGUARD INDOOR AIR QUALITY CERTIFIED mark is a registered certification mark used under license through the GREENGUARD Environmental Institute.

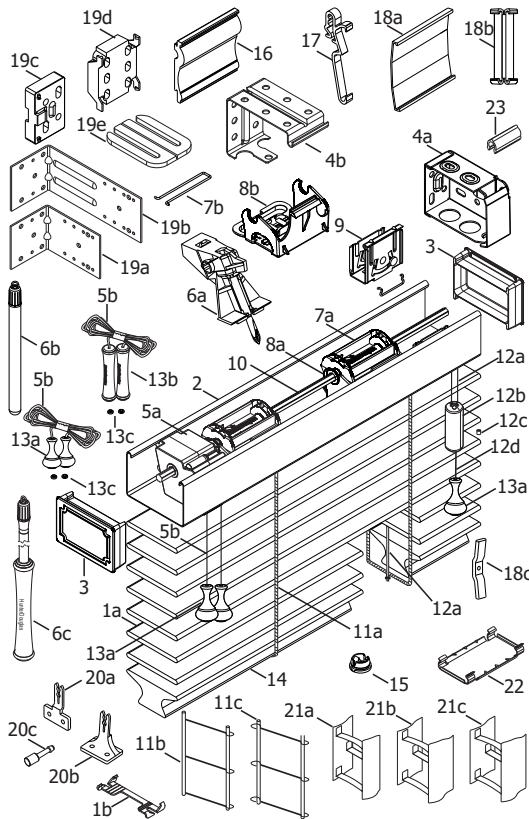

STANDARD PARTS

- 1a. Slat
- 1b. Tape Spacer
- 2. Headrail
- 3. Headrail End Cap
- 4a. Installation Bracket
- 4b. Intermediate Support Bracket
- 5a. Cord Tilter
- 5b. Tilt Cord 1.4mm
- 6a. Wand Tilter
- 6c. Decorative Tilt Wand
- 7a. Tape Roll 2" Unv. EPIC™
- 7b. Tape Roll Pin
- 8a. Tape Roll Support (Ladders)
- 8b. Tape Roll Support (Dec Tapes)
- 9. Cordlock
- 10. Tiltrod
- 11a. No Loop Cable Tape
- 11b. Single Loop Cable Tape
- 11c. Double Loop Cable Tape
- 12a. Lift Cord 1.4mm
- 12b. Cord Stop
- 12c. Cord Stop Washer
- 12d. Tassel Cord 2.2mm
- 13a. Wood Tassel
- 13b. Decorative Wood Tassel
- 13c. Lift Cord Grommet
- 14. Bottom Rail

- 15. Tape Button
- 16. Valance
- 17. Universal Valance Clip
- 18a. Valance Splice
- 18b. Universal Valance Corner Key
- 18c. Child Safety Kit (Cord Cleat)

OPTIONAL PARTS

- 19a. Short Extension Bracket
- 19b. Long Extension Bracket
- 19c. Spacer Block (Bracket)
- 19d. Spacer Block (Support Bracket)
- 19e. Bracket Shim
- 20a. Hold-Down Bracket (Jamb)
- 20b. Hold-Down Bracket (Sill)
- 20c. Hold-Down Pin
- 21a. Solid Colored Decorative Tapes (1" wide)
- 21b. Solid Colored Decorative Tapes (1½" wide)
- 21c. Patterned Colored Decorative Tapes (1½" wide)
- 22. Tape Lock
- 23. Clip

PRODUCT SPECIFICATIONS

PART 2 – PRODUCTS

2.01 ACCEPTABLE MANUFACTURER

- A. Hunter Douglas Architectural / 13915 Danielson St., Ste.100/Poway, CA 92064 / Phone: 800-727-8953 / Fax: 800-205-9819 / Website: HDarchitectural.com or architect approved equivalent.
- B. Product substitutions must be approved by architect minimum of 30 days prior to close of bid.

2.01 2" HORIZONTAL FAUX WOOD BLINDS

A. **PRODUCT:** Hunter Douglas "EverWood® 2" Horizontal Alternative Wood Blind"

B. MATERIALS:

- 1. **SLATS:** 2" wide x 0.125" thick polystyrene based polymer with consistent color throughout eliminating slat end touch-up. Furnish not less than nominal 7.2 slats per foot to ensure tight closure and light control. Finish with manufacturer's standard colors selected by architect from manufacturer's available contract colors.
- 2. **SLAT SUPPORT:** Braided ladders of 100% polyester yarn color compatible with slats and spacing of ladder no more than 16". Optional cloth tapes constructed of high strength polyester-cotton blend webbing and spacing of no more than 16". Tapes spaced to comply with industry standards for size and weight of blind.
- 3. **HEADRAIL:** U-shaped profile with rolled edges, measuring 1 1/2" x 2 1/4" x .024" constructed of corrosion resistant steel and providing a sleek low profile design. Internally fit with components required for specified performance and designed for smooth, quiet, trouble-free operation. Headrail finish to be standard baked-on polyester and to coordinate with slats. Ends fitted with zinc-coated steel end lock with adjustable tab for centering blinds.
- 4. **BOTTOM RAIL:** 2" wide x 9/16" thick polystyrene trapezoid in shape. Color-coordinated engineered polymer tape buttons secure the ladder and cord. Finish to be manufacturers standard colors or stained finish to match slats.
- 5. **LIFTING MECHANISM:** Engineering polymer and galvanized steel housing cordlocks with polymer roller bearing and steel locking dogs, two-ply polyester cord filler in braided polyester jacket lift cords meet or exceed commercial specification 1029.86, and fracture-resistant polymer cord-stop color-coordinated to slat. Located on either side of individual blind unit as per architect's request.
- 6. **TILTING MECHANISM:** Permanently lubricated and fully enclosed standard cord tilt holds and tilts slats at any angle. Solid steel, corrosion resistant tilt rod. Optional wand tilt of worm and gear construction incorporated into tilter mechanism.

- 7. **OPTIONAL TILT CONTROL WAND:** Rounded 3/8" diameter constructed of quality selected hardwood stained and lacquered or painted to match slats and detachable without tools. Located on either side of individual blind unit as per architect's request.
- 8. **MOUNTING HARDWARE:** Manufacturer's standard .030" steel box brackets with baked-on polyester finish to match headrail with additional support brackets for blinds over 48" wide.
- 9. **VALANCE:** Crafted polystyrene based polymer with finish to match slats.
- 10. **ADDITIONAL AVAILABLE OPTIONS:** de-Light™ Feature, PowerTilt™ with Platinum Technology, LiteRise® Cordless Lift System, 2 or 3 Blinds on 1 Headrail, Hold Down Brackets, Extension Brackets, Cutouts, Cloth Tapes.

2.02 FABRICATION

- A. Blind measurements shall be accurate to within + 1/8" or as recommended in writing by manufacturer.

2.04 FINISHER

- A. **SLAT** finish selection from the following: 970 White Birch, 971 Arctic Snow, 972 Porcelain, 973 Sugar Pine, 974 Parchment, 975 Winter White, 976 French Vanilla, 977 Arctic Snow Textured, 978 Porcelain Textured, 984 Extreme White, 935 Distressed Nutmeg, 936 Mocha, 937 Praline, 938 Distressed Praline, 940 Maple Toffee, 941 Natural, 942 Irish Pine, 943 Autumn Oak, 945 English Walnut, 949 Brandywine, 966 Classic Mahogany, 961 Ecru, 959 Avalanche, 962 Journal White, 960 Picket Fence, 965 Ecru Textured, 964 Picket Fence Textured, 963 Sahara, 985 Desert Sand, 986 Golden Brown, 987 Caramel, 988 Auburn Clay.
- B. **SLAT SUPPORT** braided ladders shall be color coordinated with slat. Optional 1.5" solid cloth tapes available colors: 048 Black, 064 Bronze, 082 Camel, 292 Terracotta, 293 Bordeaux, 302 Taupe, 336 Chestnut, 378 Sable, 430 Amber, 450 White, 500 Celery, 504 Moss, 572 Spruce, 613 Lake, 614 Ivory, 627 Heritage Blue, 685 Indigo, 830 Almond, 909 Country Redwood, 973 Antique White. 1.5" patterned tapes available colors: 060 Antique Stripe, 061 Chestnut Stripe, 062 Onyx Stripe, 063 Highlander Stripe, 068 Amber Stripe, 090 Black Stripe, 091 Burgundy Stripe, 092 Taupe Stripe, 093 Cream Stripe, 712 Ivory Paisley, 716 Cranberry Paisley, 717 Vienna Dawn, 718 Vienna Sunset, 719 Vienna Twilight, 720 Vienna Midnight, 723 Autumn Penny, 727 Laurel Brownstone, 820 Butterscotch, 821 Truffle, 822 Licorice, 823 Lingonberry, 824 Popcorn, 852 Nightlife, 884 Paprika, 914 Clove, 916 Glamour, 917 Sophistication, 918 Copper Luster. 1" available colors: 450-1 White, 973-1 Antique White, 830-1 Almond, 082-1 Camel, 430-1 Amber, 336-1 Chestnut, 302-1 Taupe, 378-1 Sable, 293-1 Bordeaux, 500-1 Celery, 685-1 Indigo, 048-1 Black.